

GROUP 522 GARDEN TOOLS



A high quality product that is suitable for use in garden centres, parks, sports areas industrial gardens, farms and for household use where a high quality professional product is required. The products are produced from heat treated steel which is carefully ground. These tools also have steel handles and PVC grips.



Garden Spades

Carbon steel blades. Deep sockets and swan necks for improved strength, polypropylene 'YD' handles and bend resistant shafts.



Border SBC235

Wooden shaft and plastic handle.
Overall length: 940mm
Blade size: 235 x 140mm.

Digging SBC290

Wooden shaft and plastic handle.
Overall length: 1010mm.
Blade size: 290 x 180mm.

Long Socket SBL290

Plastic shaft, soft grip plastic handle and long socket.
Overall length: 1080mm.
Blade size: 290 x 180mm.



Product Number	Type	Weight each	Order Code RTL-522
SBC235	Border		-4360K
SBC290	Digging		-4310K
SBL290	Digging		-4410K

Garden Forks

Carbon steel prongs. Deep sockets and swan necks for improved strength, polypropylene 'YD' handles and bend resistant shafts.



Border FBC235

Wooden shaft and plastic handle.
Overall length: 955mm.
Blade size: 235 x 140mm.

Digging FDC300

Wooden shaft and plastic handle.
Overall length: 1010mm.
Blade size: 300 x 185mm.

Digging Long Socket FLC300

Plastic shaft, soft grip plastic handle.
Overall length: 1080mm.
Blade size: 300 x 180mm.



Product Number	Type	Weight each	Order Code RTL-522
FBC235	Border		-4350K
FDC300	Digging		-4300K
FLC300	Digging		-4400K

Garden Spades

Polished and ground stainless steel blades with deep sockets and swan neck for improved strength. Bend resistant. Polypropylene 'YD' handles and shafts.



Digging SDS180

Suitable for general application.
Blade width: 180mm.
Overall length: 1030mm.

Border SDB150

Suitable for use in confined areas of the garden.
Blade width: 150mm.
Overall length: 910mm.



Product Number	Type	Weight each	Order Code RTL-522
SDS180	Digging	2.1kg	-2510K
SDB150	Border	1.7kg	-2560K

Garden Forks

Polished and ground stainless steel prongs with deep sockets and swan neck for improved strength. Bend resistant. Polypropylene 'YD' handles and shafts.

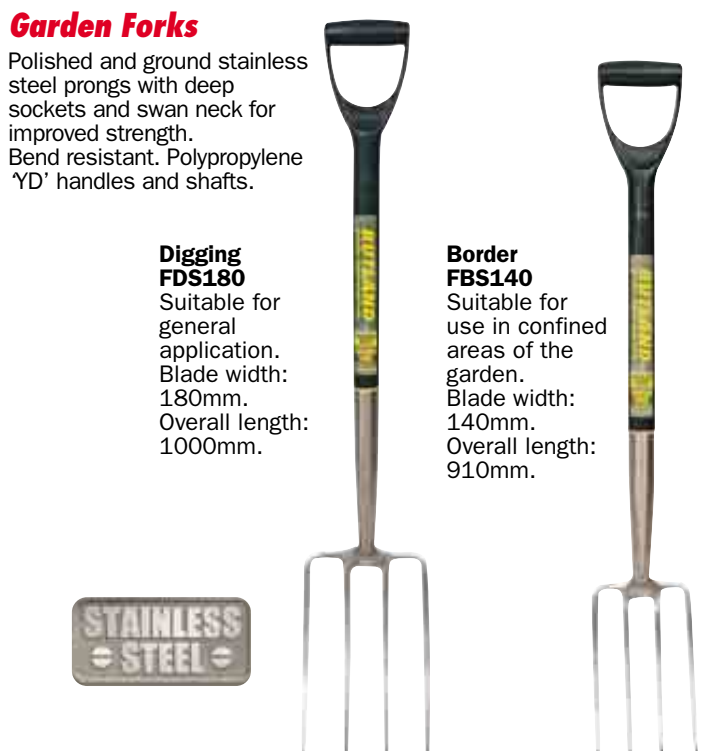

Digging FDS180

Suitable for general application.
Blade width: 180mm.
Overall length: 1000mm.

Border FBS140

Suitable for use in confined areas of the garden.
Blade width: 140mm.
Overall length: 910mm.



Product Number	Type	Weight each	Order Code RTL-522
FDS180	Digging	1.90kg	-2500K
FBS140	Border	1.60kg	-2550K

Hand Tools



A high quality product that is suitable for use in garden centres, parks, sports areas industrial gardens, farms and for household use where a high quality professional product is required. The products are produced from heat treated steel which is carefully ground. These tools also have steel handles and PVC grips.

Draw Hoe

Blade width: 140mm.
Overall length: 1550mm.



Dutch Hoe

Blade width: 128mm.
Overall length: 1600mm.



Garden Rake

Blade width: 300mm.
Overall length: 1570mm.



3 Prong Cultivator

Blade width: 90mm.
Overall length: 1620mm.



Edging Knife

Blade width: 215mm.
Overall length: 930mm.



Carbon Steel Gardening Tools

Carbon steel blades, have aluminium shafts and soft grip rubber handles.

Dutch Hoe

Blade width: 128mm.
Overall length: 1530mm.



Draw Hoe

Blade width: 140mm.
Overall length: 1410mm.



Garden Rake

Blade width: 295mm.
Overall length: 1530mm.



Lawn Rake

Blade width: 440mm.
Overall length: 1530mm.



Type	Weight each	Order Code
Draw Hoe		RTL-522
Edging Knife		-2770K
Dutch Hoe		-2700K
Rake		-2750K
Cultivator		-2800K
		-2840K

Type	Weight each	Order Code
Dutch Hoe		-4800K
Draw Hoe		-4820K
Garden Rake		-4900K
Lawn Rake		-4920K

PRODUCTS ARE ONLY AVAILABLE VIA YOUR DISTRIBUTOR

GROUP 522 GARDEN TOOLS

RUTLAND™ Stainless Steel Fork & Trowel
Quality Gardening Tools

Stainless steel blades with plastic handles.

Hand trowel:
300 x 81mm.



Weeding fork:
270 x 76mm.



Graduated bulb planter:
300 x 65mm.



Overall dimensions: W205 x D60 x H310mm.

Type	Weight each	Order Code
Hand Trowel	255g	-2410K
Weeding Fork	170g	-2400K
Bulb Planter	205g	-2420K
Fork & Trowel 3 Piece Set		
Contents as above	825g	-2450K

Carbon Steel Fork & Trowel

Hammered epoxy coated carbon steel blades. Varnished wooden handles.

Hand trowel:
285 x 87mm.



Weeding fork:
285 x 80mm.



Graduated bulb planter:
290 x 63mm.



Overall dimensions: W205 x D60 x H310mm.

Type	Weight each	Order Code
Hand Trowel	200g	-4210K
Weeding Fork	230g	-4200K
Bulb Planter	235g	-4220K
Fork & Trowel 3 Piece Set		
Contents as above	900g	-4250K

Single Hand Grass Shears

Spring loaded non-stick blades, blade rotation with locking mechanism. For left or right hand use.

360° Blades Rotate

Overall blade length: 200mm.



Blade Rotation	Weight each	Order Code
360°		-2020K

Bypass Secateurs

Bypass secateurs with a non-clogging telescopic spring and single handed locking mechanism.



Standard Duty

Contoured rubber grip handles. Maximum cutting diameter: 25mm. Overall length: 200mm.



Heavy Duty

Textured rubber grip handles. Overall length: 215mm.



Type	Weight each	Order Code
Standard Duty		-1600K
Heavy Duty		-1750K

Pruning Shears

Spring loaded, with contoured grips and blade locking mechanism. Overall length: 200mm.

Anvil Action

The anvil secateur is designed for cutting old, hard and deadwood. The anvil supports a wide area of the branch while the sharp narrow upper blade is forced through the wood with only a minimum amount of slicing action.



Bypass Action



Type	Weight each	Order Code
Anvil Action		-2050K
Bypass Action		-2100K

Flora Secateurs

Long nose secateurs for delicate pruning jobs. Textured cushioned grip for user comfort. Maximum cutting diameter: 30mm.



Overall Length	Weight each	Order Code
180mm		-1550K

Hand Tools



Anvil & Bypass Loppers

All with powder PVC coated, round tubular steel handles and foam rubber grips.



Bypass

The bypass lopper is designed for cutting live (green) wood or stems. The cutting blade of the lopper passes a counterblade in a scissor bypass action. The pivot point of the Rutland lopper is slightly offset from the centre line of cutting; this creates a slicing action during cutting, which greatly reduces the effort required when pruning live wood and spreads wear over the full length of the blade. For accurate pruning and clean cuts. Compound jaw action. Maximum cutting diameter: 60mm. Overall length: 760mm.

The anvil lopper is designed for cutting old, hard and deadwood. The anvil supports a wide area of the branch while the sharp narrow upper blade is forced through the wood with only a minimum amount of slicing action. Anvil draw action prevents branch slippage. Cuts with minimum effort. Compound jaw action. Maximum cutting diameter: 60mm. Overall length: 730mm.

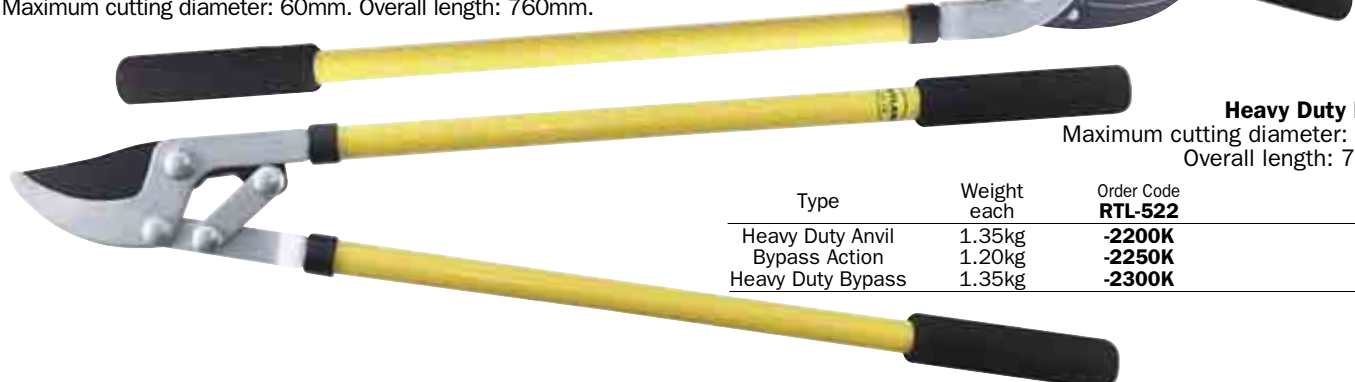

Heavy Duty Bypass
Maximum cutting diameter: 50mm.
Overall length: 760mm.

Type	Weight each	Order Code RTL-522
Heavy Duty Anvil	1.35kg	-2200K
Bypass Action	1.20kg	-2250K
Heavy Duty Bypass	1.35kg	-2300K

Bow Saws

All models feature lever tension handles for rapid blade change and rigid oval section frames. Supplied with clip-on plastic blade protectors to prevent injuries during transportation and storage. Suitable for cutting dry and green wood. Suitable for gardeners, landscapers, builders, farmers etc. Standard duty suitable for occasional use e.g. DIY, gardener etc. Heavy duty suitable for regular use e.g. professional landscapers etc.

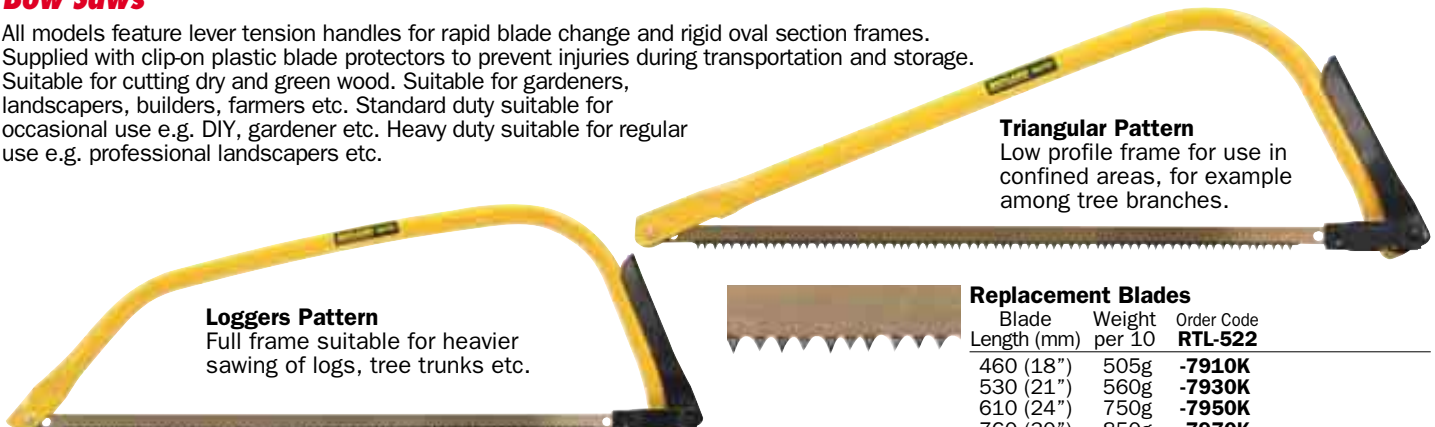

Loggers Pattern
Full frame suitable for heavier sawing of logs, tree trunks etc.

Triangular Pattern
Low profile frame for use in confined areas, for example among tree branches.



Replacement Blades

Blade Length (mm)	Weight per 10	Order Code RTL-522
460 (18")	505g	-7910K
530 (21")	560g	-7930K
610 (24")	750g	-7950K
760 (30")	850g	-7970K

Type	Duty (Weight)	Blade Length (mm)	Throat Length	Weight each	Order Code RTL-522
Triangular	Standard	460 (18")	-	480g	-7180K
Logging	Standard	530 (21")	-	480g	-7210K
Triangular	Heavy	530 (21")	-	540g	-7310K
Logging	Heavy	610 (24")	180mm	700g	-7340K
Logging	Heavy	760 (30")	230mm	820g	-7400K

Folding Pruning Saw

Contoured grip with push button locking mechanism. Overall length: closed: 230mm, opened: 440mm.



Overall Length	Weight each	Order Code RTL-522
440mm	240g	-6600K

Hedge Shears

Plastic handles fitted with 'anti-jam' shock absorbers. Blades can be separated for regrinding.



Overall Length	Weight each	Order Code RTL-522
500mm	1.20kg	-2150K

Heavy Duty Hedge Shears

Round tubular steel powder coated handles with rubber foam grips. Fitted with 'anti-jam' shock absorbers. Blades can be separated for regrinding.



Overall Length	Weight each	Order Code RTL-522
600mm	1.20kg	-2350K

PRODUCTS ARE ONLY AVAILABLE VIA YOUR DISTRIBUTOR

GROUP 522 GARDEN TOOLS

RUTLAND Square Mouth Shovels
CONTRACTORS TOOLS

High-tensile tubular steel construction with metal 'YD' handle which is designed for heavy industrial and professional use. Shovel head is finished in a tough epoxy powder coating which prevents rusting and reduces soil adhesion.



SSC190

Type: open socket
Handle type: YD polypropylene.
Shaft: metal.
Blade material: carbon steel, epoxy coated.
Blade width: 190mm.
Blade height: 300mm.
Overall length: 975mm.

SSC245

Type: open socket.
Handle Type: YD polypropylene.
Shaft: metal.
Blade material: carbon steel, epoxy coated.
Blade width: 245mm.
Blade height: 300mm.
Overall length: 965mm.

SSC265

Type: all metal.
Handle type: YD metal framed.
Shaft: metal.
Blade material: carbon steel, epoxy coated.
Blade width: 255mm.
Blade height: 265mm.
Overall length: 1030mm.

Product Number	Weight each	Order Code RTL-522
SSC190		-4510K
SSC245		-4500K
SSC265		-8080K



Pick Axe Head

Chisel & Point

Solid forged from a single piece of steel, hardened to penetrate the hardest rocky soil. Robust and durable for optimum performance.



Type	Weight each	Order Code RTL-522
Chisel & Point	3.20kg	-4050K

Asphalt & Tarmac Rakes

With tubular steel handle, long tang and solid steel painted head with 16 teeth for evenly spreading loose stocks of tarmac and asphalt.



Asphalt Rake

With 16 flat teeth.
Overall length: 1550mm.
Head width: 406mm.

Tarmac Rake

With 16 round teeth.
Overall length: 1550mm.
Head width: 406mm.

Square & Round Mouth Shovels

Black finish, heat treated blades and hardwood shafts. Bend resistant. Polypropylene 'YD' handles.



SSC215

Type: open socket.
Handle type: YD polypropylene
Shaft: hardwood.
Blade material: carbon steel, powder coated, varnished.
Blade width: 215mm.
Blade height: 300mm.
Overall length: 1020mm.

SRC230

Type: open socket.
Handle type: YD polypropylene.
Shaft: hardwood.
Blade material: carbon steel, powder coated, varnished.
Blade width: 230mm.
Blade height: 300mm.
Overall length: 1010mm.

Product Number	Weight each	Order Code RTL-522
SSC215	1.10kg	-5580K
SRC230	1.80kg	-5590K



Type	Weight each	Order Code RTL-522
Asphalt Tarmac		-8000K
		-8020K

Hand Tools



RUTLAND *Taper Mouth*
CONTRACTORS TOOLS *Shovels & Fork*

High-tensile tubular steel construction with metal 'MYD' handle which is designed for heavy industrial and professional use. Finished in a tough epoxy powder coating which prevents rusting and reduces soil adhesion.

STC190

Type: all metal.
Handle type: MYD
metal framed.
Shaft: metal.
Blade material:
carbon steel,
epoxy coated.
Blade width:
190 - 165mm.
Blade height: 280mm.
Overall length: 990mm.



FSC210

Type: all metal.
Handle type: MYD
metal framed.
Shaft: metal.
Blade material:
carbon steel,
epoxy coated.
Blade width: 210mm.
Blade height: 325mm.
Overall length:
1040mm.



STC240

Type: all metal.
Handle type: YD
metal framed.
Shaft: metal.
Blade material:
carbon steel,
epoxy coated.
Blade width: 240 - 215mm.
Blade height: 265mm.
Overall length: 1030mm.



Product Number	Weight each	Order Code
STC190	1.10kg	-8160K

Product Number	Weight each	Order Code
FSC210	1.80kg	-8240K

Product Number	Weight each	Order Code
STC240	1.80kg	-8060K

Cable Laying & Draining Tools

High-tensile tubular steel construction designed for heavy industrial and professional use. Shovel head is finished in a tough epoxy powder coating which prevents rusting and reduces soil adhesion.

Cable Laying Shovel

All steel with slightly dished blade and round cutting edges. Designed for clay digging and heavy ground breaking work.

CLC140

Type: all metal.
Handle type: MYD
metal framed.
Shaft: metal.
Blade material: carbon
steel, epoxy coated.
Blade width:
140 - 115mm.
Blade height: 280mm.
Overall length: 990mm.



Newcastle Drainer

Ideal for digging trenches, pipe, cable and drain channels and post holes.

NCD165

Type: all metal.
Handle type: MYD
metal framed.
Shaft: metal.
Blade material: carbon
steel, epoxy coated.
Blade width:
165 - 100mm.
Blade height: 400mm.
Overall length: 1115mm.



Grafting Spade

All steel with a slightly dished head. Ideal for digging post holes in confined spaces.

GSC140

Type: all metal.
Handle type:
straight metal.
Shaft: metal.
Blade material: carbon
steel, epoxy coated.
Blade width:
140 - 127mm.
Blade height: 280mm.
Overall length: 1650mm.



Product Number	Weight each	Order Code
CLC140		-8340K
NCD165		-8500K
GSC140		-8320K

PRODUCTS ARE ONLY AVAILABLE VIA YOUR DISTRIBUTOR

GROUP 522 GARDEN TOOLS

RUTLAND™ Premier Gardening Set
Quality Gardening Tools

Contents:

Stainless steel hand trowel, weeding fork and bulb planter. Digging spade and fork, stainless steel blades/prongs with deep sockets, bend resistant with polypropylene 'YD' handles and shafts. Garden rake and dutch hoe both with stainless steel heads, steel handles and PVC grips. Bypass secateurs with contoured rubber grip - max cutting diameter 25mm. Heavy duty tough woven polythene garden bag with 170 litre capacity. 1 pair of heavy duty Canadian rigger gloves size 10.

**10
PIECES**

Country Gardening Set

Contents:

Carbon steel hand trowel, weeding fork and bulb planter. Digging spade and fork, both with ground carbon steel blades/prongs with deep sockets, bend resistant with polypropylene 'YD' handles and shafts. Garden rake, dutch hoe and lawn rake all with carbon steel heads, aluminium handles and soft rubber grips. Bypass secateurs with contoured rubber grip - max cutting diameter 25mm. Heavy duty tough woven polythene garden bag with 170 litre capacity. 1 pair of heavy duty Canadian rigger gloves size 10.

**11
PIECES**



Description	Weight each	Order Code
10 Piece Gardening Set		RTL-522 -9120K

Description	Weight each	Order Code
11 Piece Gardening Set		RTL-522 -9100K

Pruning Set

Contents:

Triangular bow saw, 460mm overall length. Bypass loppers with powder coated round tubular steel handles and foam rubber grips, maximum cutting diameter 60mm. Heavy duty hedge shears with anti-jam shock absorbers. Heavy duty bypass secateurs with textured rubber grip, max cutting diameter 25mm. Folding pruning saw with push button locking, 200mm blade length. Carbon steel hand trowel and weeding fork. Heavy duty tough woven polythene garden bag with 170 litre capacity. 1 pair of heavy duty Canadian rigger gloves size 10.



**9
PIECES**

Description	Weight each	Order Code
9 Piece Pruning Set		RTL-522 -9140K

Hand Tools

PRODUCTS ARE ONLY AVAILABLE VIA YOUR DISTRIBUTOR

RUTLAND
Quality Gardening Tools

**Wall Mounted
Hose Reel Holder**

Heavy duty hose reel, stores up to 60m (200ft) of 1/2" hose. Made from strong steel complete with wall fitting bracket. For use in the garden or on building sites.
Hose not included.



Capacity	Weight each	Order Code
60m/200ft		RTL-523 -9060K

Hose Trolley

This large capacity trolley stores up to 60m of 13mm (1/2") hose or 45m of 16mm (5/8") hose. It is easy to assemble — snap and click, needs no tools. It has a sturdy frame with a rust and corrosion-resistant coating.
Hose not included.



Capacity	Weight each	Order Code
60m/200ft		RTL-523 -4100K

30m Garden Hose Set

30m Standard reinforced garden hose, bore size 13mm. Complete with snap action spray nozzle, female water stop, female fitting and universal tap connector.



5
PIECES

Size	Weight each	Order Code
30mtrs		RTL-523 -4120K

Garden Hoses

Multi-purpose three layer braided garden hose. Five year guarantee. Bore size 13mm.



Size	Weight each	Order Code
30mtrs		RTL-523 -4020K
50mtrs		-4040K

Hose Reel Set

This hose reel comes complete with 15m hose and fittings. It is easy to assemble - snap and click, needs no tools and with added hose can store up to 60m of 13mm hose.



15m

8
PIECES

Size	Weight each	Order Code
15mtrs		RTL-523 -4140K

Hose Tidy

This wall mounting bracket provides a tidy solution to the storage of garden hose and fittings. Hose and fittings not supplied.



Type	Weight each	Order Code
Hose Tidy		RTL-523 -4090K

Coil Hose Sets

These hose coil sets come complete with a seven pattern spray gun, heavy duty snap action connectors and a threaded tap connector. It is light in weight, does not kink or tangle and provides superior waterflow control.

Spray patterns:

- Soaker.
- Mist.
- Shower.
- Jet.
- Flat.
- Centre.
- Cone.



3
PIECES

Size	Weight each	Order Code
15mtrs		RTL-523 -3940K
30mtrs		-3960K

Hose Reel Set

This hose reel set comes complete with 30m hose and fittings. It is easy to assemble - snap and click, needs no tools. It can store up to 45m of 16mm hose or 60m of 13mm hose.



30m

8
PIECES

Size	Weight each	Order Code
30mtrs		RTL-523 -4080K

GROUP 523 GARDEN WATERING PRODUCTS

RUTLAND™ Quality Gardening Tools **Spray Nozzle Starter Set**

Four piece spray nozzle set with nozzle, water stop hose connector, hose connector and tap adaptor.



Type	Weight each	Order Code
Spray Nozzle Starter Set		RTL-523
		-4160K

Adjustable Hose Nozzle

Spray nozzle is adjusted by twisting one part of the body against the other to get the shape/strength of flow required.



Type	Weight each	Order Code
Adjustable Hose Nozzle		RTL-523
		-4600K

Brass Outdoor Tap Set

A complete set for installing an outside tap, supplied with a complete set of plastic fittings.



Type	Weight each	Order Code
Brass Outdoor Tap Set		RTL-523
		-9550K

1/2" Water Stop Hose Connector

Water stop valve to cut off supply as soon as the connection is disconnected and is ideal for connecting to implements.



Type	Weight each	Order Code
1/2 Water Stop Hose Connector		RTL-523
		-4580K

Universal Tap Connector

This male snap action connector can be attached to any tap with either a 1/2" or 3/4" BSP fitting.



Type	Weight each	Order Code
Universal Tap Connector		RTL-523
		-4530K

Clamp-on Tap Connector

This male snap action tap connector has a flexible coupler on the other end which fits most taps and is then tightened onto the tap by twisting the butterfly screw.

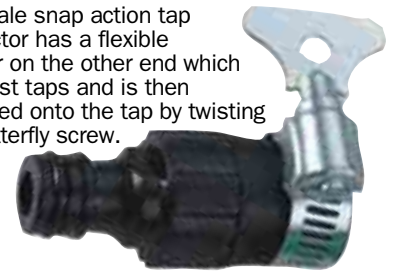

Type	Weight each	Order Code
Clamp Tap Connector		RTL-523
		-4500K

2 Way Male Snap Action Connector

This fitting is for connecting two hoses with both having female fittings on the end.

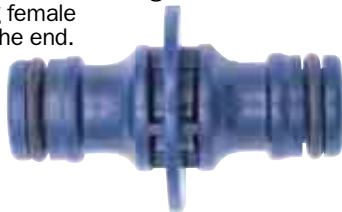

Type	Weight each	Order Code
2 Way Male Connector		RTL-523
		-4460K

Multi-purpose Tap Connector

This male snap action connector is for connecting a hose onto most modern taps, including mixers.



Type	Weight each	Order Code
Multi-Purpose Tap Connector		RTL-523
		-4540K

Large Square Mixer Tap Connector

Fits large or square taps, fits direct to hose. Fits 13mm hose.



Type	Weight each	Order Code
Square Mixer Tap	180g	RTL-523
		-9560K

3 Way Male Snap Action Connector

For splitting one supply hose into two outlets, with all three hoses having female snap action connectors.



Type	Weight each	Order Code
3 Way Male Connector		RTL-523
		-4470K

Hose End Connector

This fitting is for use on the end of the hose which connects to the supply.



Type	Weight each	Order Code
Hose End Connector		RTL-523
		-4520K

13mm (1/2") Hose Joiner

This fitting is used for either mending or joining hoses.



Type	Weight each	Order Code
Hose Joiner		RTL-523
		-4480K

Hand Tools

RUTLAND Quality Gardening Tools **Heavy Duty Spray Gun**

6 Pattern Chromed Spray Gun

Heavy duty chrome spray gun, designed to be used for all gardening and general purpose tasks.

Spray settings:

- Soaker.
- Shower.
- Jet.
- Flat.
- Mist.
- Cone.



HEAVY DUTY

6 PATTERN

Type	Weight each	Order Code
Spray Gun		RTL-523 -9260K

Spray Gun

This seven pattern spray gun has a comfort grip, locking trigger and snap action connector.

Spray settings:

- Soaker.
- Shower.
- Circle.
- Jet.
- Flat.
- Mist.
- Cone.



7 PATTERN

Type	Weight each	Order Code
Spray Gun	170g	RTL-523 -4240K

Oscillating Sprinkler

This oscillating sprinkler has a gear drive operation for even, gentle lawn watering. Coverage levers enable easy adjustment to your required oscillation width, giving a coverage of about 200m³ (depends on water pressure, length and bore of hose).



Type	Weight each	Order Code
Oscillating Sprinkler		RTL-523 -4400K

Brass Spray Gun

This spray gun is easy to control and has a locking trigger, comfort grip and snap action fitting.



Type	Weight each	Order Code
Brass Spray Gun		RTL-523 -4220K

Chrome Spray Gun

This heavy duty spray gun has six spray patterns, is easy to control with a comfortable grip, locking trigger and snap action connector.

Spray settings:

- Shower.
- Centre.
- Stream.
- Flat.
- Mist.
- Full.



6 PATTERN

HEAVY DUTY

Type	Weight each	Order Code
Chrome Spray Gun	25g	RTL-523 -4230K

Rotating Sprinkler

This sprinkler features a minimal footprint for lawn protection, a spray coverage up to 20m², depending on the pressure of the water supply.



Type	Weight each	Order Code
Rotating Sprinkler		RTL-523 -4420K

Spray Lance

This spray lance has a pivoting head and telescopic body, making it an invaluable asset when watering hanging baskets, window boxes etc. in any location. The telescopic arm expands from: 90cm (36") to 135cm (53").

Spray settings:

- Soaker.
- Shower.
- Centre.
- Jet.
- Flat.
- Mist.
- Cone.

7 PATTERN

EXTENDS TO 135cm



Type	Weight each	Order Code
Spray Lance	230g	RTL-523 -4440K

Spray Gun Set

This spray gun set comprises: Six pattern spray gun with locking trigger and snap action connector, female water stop, female fitting and universal tap connector.

Spray settings:

- Shower.
- Centre.
- Stream.
- Flat.
- Mist.
- Full.

4 PIECES



Type	Weight each	Order Code
Spray Gun Set	170g	RTL-523 -4200K

Impulse Sprayer

This sprinkler has a minimal footprint for lawn protection, fully adjustable distance and spray pattern with full or part circle operation and a spray coverage of up to 24m².



Type	Weight each	Order Code
Impulse Sprayer		RTL-523 -4380K

GROUP 523 GARDEN WATERING PRODUCTS

RUTLAND™ Garden Knapsack Sprayers
Quality Gardening Tools

Can be used for left or right handed operation. Spray lance with locking trigger and four adjustable nozzles, that clips onto handle for storage. Pressurising pump handle with grip and storage loop. Pressure release valve. Adjustable webbing shoulder straps.



Size	Weight each	Order Code
16ltr	3.50kg	-4300K
20ltr	4.00kg	-4280K



16ltr capacity blow-moulded container with filter and fluid level graduations.

20ltr capacity blow-moulded container with filter and fluid level graduations long reach.

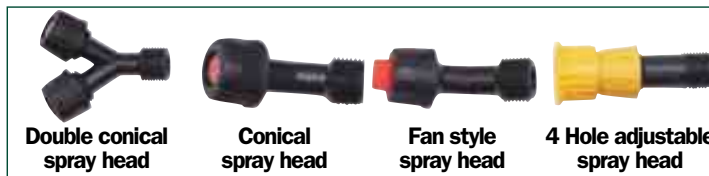

Pressure Sprayer

Five litre capacity blow-moulded container with fluid level graduations. Spray lance with trigger and adjustable nozzle. Pressure release valve. Adjustable webbing shoulder strap.



Capacity	Weight each	Order Code
5.0ltr	1.11kg	-4320K

Hand Sprayer

High quality hand held sprayer manufactured from ABS plastic which is both shatter-proof and frost-resistant. For use with chemicals around the garden.



Capacity	Weight each	Order Code
1.5ltr		-4360K

Galvanised Watering Cans

Removable brass rose head. With reinforced nozzle and side handle.



Capacity	Weight each	Order Code
8.0ltrs		-4800K
13.5ltrs		-4820K

Trigger Hand Sprayer

Manufactured from Polyethylene these robust trigger spray dispensers are suitable for many home & garden applications, will dispense various water based detergents, insecticides, soluble plant food, solvents and cleaning agents.



Capacity	Weight each	Order Code
500ml		-4900K
740ml		-4920K
1000ml		-4940K

Gardener's Kneeling Pad

Designed for ease of use and user comfort, lightweight and durable with single grab handle. Manufactured from easy to clean water-resistant dense EVA foam, 18mm thick.

Dimensions: 180 x 406 x 18mm.



Material	Weight each	Order Code
EVA Foam	121g	-9700K

Plastic Watering Can

Eight litre capacity with removable plastic rose.



Capacity	Weight each	Order Code
10ltrs		-4840K

Hand Tools

RUTLAND Quality Gardening Tools **Pop-Up Garden Waste Bag**

Made from rot-proof woven polyethylene fabric with tear resistant stitching for durability. This 170ltr garden waste bag comes flat pack, compressed and held down with loops and toggles for ease of storage. Perfect for grass cuttings, autumn leaves and general garden waste. Can be used for other purposes such as dirty linen/laundry collection, wood shaving/saw dust collection. Self supporting, it makes filling easier and with a 20kg max load you can fill it with as much as you can carry.



NEW



Type	Weight each	Order Code
Pop-Up Waste Bag	800g	RTL-523 -4720K

Heavy Duty Garden Bag

170 litre capacity garden bag with a unique strengthener around the mouth and three handle design. Tough woven polyethylene fabric with tear resistant stitching for longer usage. UV treated for extra long life and stays rot-proof for years.



Type	Weight each	Order Code
Heavy Duty Garden Bag		RTL-523 -9800K

Polypropylene Bulk Bag

Used to ship or store a wide variety of bulk materials. Suitable for: building materials, cement, food ingredients, mineral and quarried products, seed, fertiliser, salt, potatoes and garden waste. Safe Working Load (SWL): 1000kg. Supplied with Test Certificate.



NEW

Size (mm) (W x L x H)	Pack Quantity	Order Code
850 x 850 x 870		RTL-523 -4740K

Blue Rubble Sacks - on a Roll

Extra strong recycled polythene refuse sacks. Suitable for garden and building site use. Roll of seven bags.



Size (mm) (W x L x H)	Pack Quantity	Order Code
510 x 510 x 760	7 100	RTL-523 -4760K -4770K

Light Weight Garden Bag

170 litre capacity garden bag with two handles. Made from rot-proof woven polyethylene fabric with tear resistant stitching for durability.



Type	Weight each	Order Code
Light weight Garden Bag	220g	RTL-523 -4700K