

**GROUP
300**

**DIAL
GAUGES**



Pages **224 - 225**

**GROUP
302**

**AXIS
GAUGING**



Page **226**

**GROUP
303**

**HARDNESS
TESTERS**



Page **227**

**GROUP
306**

**GRANITE
BLOCKS &
PLATES**



Page **228**

**GROUP
314**

**MECHANICAL
COUNTERS**



Page **229**

**GROUP
315**

**BORE
GAUGES**



Page **230**

**GROUP
316**

**EYE LOUPES &
MAGNIFIERS**



Pages **230 - 231**

**GROUP
318**

MICROSCOPES



Page **235**

**GROUP
318**

BINOCULARS



Pages **232 - 233**

**GROUP
330**

**HEIGHT
GAUGES**



Page **236**

**GROUP
330**

**PROTRACTORS &
COMBINATION
SETS**

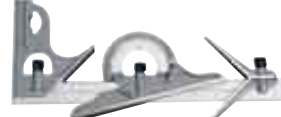

Page **237**

**GROUP
330**

**DIAL CALIPERS
& THICKNESS
GAUGES**



Pages **238 - 241**

**GROUP
330**

**VERNIER CALIPERS
& THICKNESS
GAUGES**



Page **238**

**GROUP
331**

**DIGITAL
CALIPERS**



Pages **240 - 241**

**GROUP
331**

**DIGITAL
GAUGES**



Page **241**

**GROUP
331**

**DIGITAL
INDICATORS**



Page **242**

**GROUP
331**

**DIGITAL
MICROMETERS**



Page **242**

**GROUP
333**

**MAGNETIC
BASES &
FITMENTS**



Pages **243 - 245**

**GROUP
335**

MICROMETERS



Pages **246 - 251**

**GROUP
336**

REFRACTOMETERS



Page **252**

**GROUP
338**

**GAUGE
BLOCKS**



Page **252**

**GROUP
360**

**SCREW PLUG
GAUGES**



Page **253**

**GROUP
361**

**SCREW RING
GAUGES**



Page **253**

**GROUP
370**

**STEEL BLOCKS &
PLATES**



Page **254**

Section 3 Contents

3

Description	Group	Page
Axis Gauging	302	226
Bevel Protractors	330	237
Binoculars	318	232 - 233
Bore Gauges	315	230
Calipers & Thickness Gauges - Dial	330	239
Digital	331	240 - 241
Vernier	330	238
Combination Sets	330	237
Digital Indicators & Micrometers	331	242
Dial Gauges	300	224 - 225
Engineer's Levels & Squares	340	253
Eye Loupes & Magnifiers	316	230 - 231
Gauge Blocks	338	252
Granite Vee Blocks, Squares & Surface Plates	306	228
Hardness Testers	303	227
Height Gauges	330	236
Magnetic Bases & Comparator Stands	333	243 - 245
Micrometers	335	246 - 251
Microscopes	318	235
Refractometers	336	252
Screw Gauges	360	253
Steel Parallels	372	255
Steel Vee Blocks, Squares & Surface Plates	370	254
Stopwatches & Counters	314	229
Thermometers	312	229
Thickness Gauges	330	236

Precision & Laboratory Equipment

Section 3
Product Groups
300 - 372



GROUP 300 DIAL GAUGES

OXFORD PRECISION Easy Read Dial Gauges Plunger Type



58mm (2 1/4") Diameter Dial
Matt finish chromed housings and black oxidised limit hands. Shockproof mechanism. Fitted with 1/4" inside diameter stem. Manufactured to **BS 907**.



58mm Diameter

Spares to suit Oxford Plunger Type Gauges

Description	Order Code
Anvil - mm	-9400K

Graduation	Travel	Reading	Weight each	Order Code
0.001"	0.5"	0 - 50 - 0	440g	-8100K
0.01mm	5mm	0 - 50 - 0	350g	-7850K
0.01mm	10mm	0 - 100	440g	-8500K
0.01mm	25mm	0 - 100	440g	-8520K

KENNEDY Easy Read Dial Gauges Plunger Type



58mm (2 1/4") Diameter Dial
Easy Read Dial Gauges and DTI's are designed for countless applications and available in two basic styles. With shockproof mechanisms and clear, 'Easy Read' dial for zero setting. All models are operational in both directions. Supplied in fitted cases with accessories storage space.



58mm Diameter

Matt finish chromed housings and black oxidised limit hands. Fitted with 1/4" inside diameter centre back lug and 5/16" diameter stem. Manufactured to **BS 907**.

Spares to suit Kennedy Plunger Type Gauges

Description	Order Code
Anvil - mm	-9400K

Graduation	Travel	Reading	Weight each	Order Code
0.001"	0.5"	0 - 50 - 0	440g	-7100K
0.001"	0.5"	0 - 100	440g	-7110K
0.0005"	0.5"	0 - 25 - 0	440g	-7120K
0.001"	1.0"	0 - 100	440g	-7160K
0.0005"	1.0"	0 - 50	440g	-7170K
0.01mm	10mm	0 - 100	440g	-7500K
0.01mm	25mm	0 - 100	440g	-7520K

KENNEDY Smile Dial Dial Gauges Plunger Type



58mm (2 1/4") Diameter Dial
Matt finish chromed housings and black oxidised limit hands. Jewelled. and 5/16" diameter stem. Fitted with 1/4" inside diameter centre back lug and 5/16" diameter stem. Manufactured to **BS 907**.



JEWELLED

58mm Diameter

Spares to suit Kennedy Plunger Type Gauges

Description	Order Code
Anvil - mm	-9400K

Graduation	Travel	Reading	Weight each	Order Code
0.01mm	10mm	0 - 100	440g	-5000K

OXFORD PRECISION Easy Read Dial Gauge Plunger Type



58mm (2 1/4") Diameter Dial 6 Jewel
Matt finish chromed housings and black oxidised limit hands. Shockproof mechanism. Fitted with 1/4" inside diameter stem. Manufactured to **BS 907**.



JEWELLED

58mm Diameter

Graduation	Travel	Reading	Weight each	Order Code
0.01mm	10mm	0 - 100	440g	-5500K
0.01mm	25mm	0 - 100	440g	-5520K



Lever Type

Supplied with dovetail fitting and 6 and 8mm spigot. Matt finish chromed housing.

32mm Diameter Dial



Spares to suit Oxford Dial Test Indicators

Description	Order Code
Replacement Stylus	-9630K
Universal Holder	-9840K

Description	Order Code
1/4" Spigot - 6mm Stem	-0340K
1/4" Spigot - 8mm Stem	-0350K

Graduation	Travel	Reading	Weight each	Order Code
0.01mm	0.8mm	0-40-0	170g	-9020K

1 1/4" Dial Diameter



Spares to suit Oxford Dial Test Indicators

Description	Order Code
Replacement Stylus	-9630K
Universal Holder	-9840K

Description	Order Code
1/4" Spigot - 6mm Stem	-0340K
1/4" Spigot - 8mm Stem	-0350K

Graduation	Travel	Reading	Weight each	Order Code
0.0005"	0.03"	0-15-0	170g	-9010K

Lever Type - Dual Reading

43mm (1 1/16") Diameter Dial
Matt finish chromed housing and black oxidised limit hands. Supplied with dovetail fitting and 1/4" spigot. Jewelled. Manufactured to **BS2795**.



Spares to suit Kennedy Dial Test Indicators

Description	Order Code
Replacement Stylus	-9420K

Description	Order Code
1/4" Spigot - 6mm Stem	-0340K
1/4" Spigot - 8mm Stem	-0350K

Graduation	Travel	Reading	Weight each	Order Code
0.0005"	0.3"	0-25-0	180g	-4000K
0.01mm	0.6mm	30-0-30		

Lever Type

Supplied with dovetail fitting and 6 and 8mm spigot. Matt finish chromed housing. Jewelled.

32mm (1 1/4") Diameter Dial

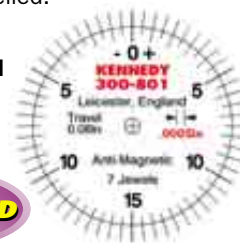

Spares to suit Kennedy Dial Test Indicators

Description	Order Code
Replacement Stylus	-9630K

Description	Order Code
1/4" Spigot - 6mm Stem	-0340K
1/4" Spigot - 8mm Stem	-0350K

Graduation	Travel	Reading	Weight each	Order Code
0.0005"	0.03"	0-15-0	170g	-8010K
0.01mm	0.8mm	0-40-0	170g	-8020K

41mm (1 5/8") Diameter Dial Jewelled



Spares to suit Kennedy Dial Test Indicators

Description	Order Code
Replacement Stylus	-9630K

Description	Order Code
1/4" Spigot - 6mm Stem	-0340K
1/4" Spigot - 8mm Stem	-0350K

Graduation	Travel	Reading	Weight each	Order Code
0.002mm	0.2mm	0-10-0	190g	-8040K

GROUP 302 AXIS GAUGING

KENNEDY 3D Axis Gauging
QUALITY INDUSTRIAL TOOLING



The New Generation of NC axis gauging equipment, for quick, accurate setting of all three axes (X, Y, Z) by analogue differential indicator. Suitable for all machine tools with CNC, NC or DRO and also for EDM/spark erosion tools - the stylus is electrically insulated from the spindle. Universal - one tool measures length, height, diameter and centre. The synchronous single needle allows greater needle displacement before reaching '12 o'clock'. A positive reading is given regardless of direction of axis movement. No calculations and no 'trial and error' involved. Increases production and efficiency, reduces job time and operator requirement. The stylus is designed to break on a 'nominal fracture' before the workpiece or tester can be damaged. Three plug in styli types can be changed in seconds without the use of special tools. Pre-adjusted to a concentricity of 0.01mm maximum.

Indicator diameter: 50mm.
Clamping shank diameter: 20mm.

a. Measuring length

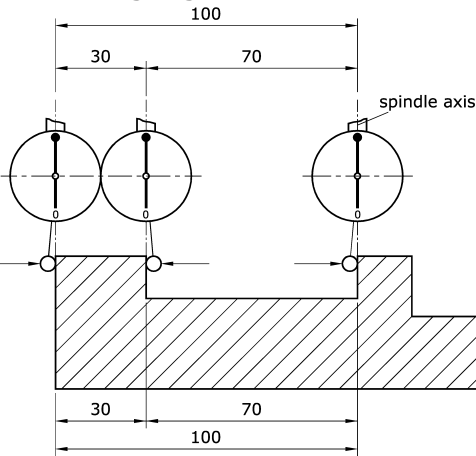

b. Measuring height

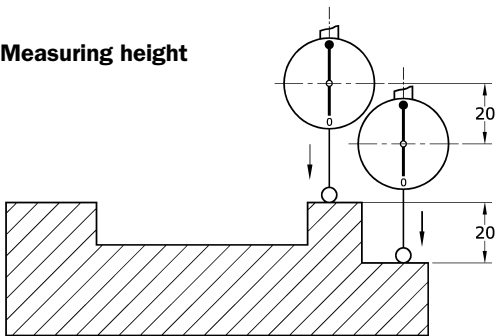

c. Establishing true centre and diameter of bores.

Insert stylus roughly in centre of bore, measure distance A and divide by 2 (P). Measure distance B in Y direction, across point P and divide by 2. Result: true centre point (M). Repeat measuring of distance A.

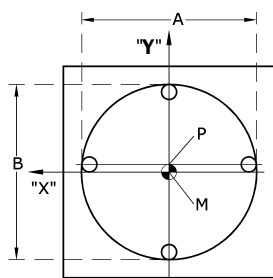

3D Axis Gauge

Indicator Dia.	Effective Length	Shank Dia.	Weight each	Order Code
50mm	125mm	20mm	89g	KEN-302 -2000K

Stylii

Conical precision plug-in mechanism. Insulated, no electrical conductivity. Designed-in nominal fracture point.

Type	Length mm	Anvil Dia.	Weight each	Order Code
Short	33	3.0	3g	-2030K
Standard	46	4.0	5g	-2050K
Long	72	6.0	10g	-2100K



Rockwell Hardness Tester

Model 150R

For testing the hardness of hard alloys, quenched and unquenched steels, using steel ball or diamond penetrators to measure Rockwell A, B & C units of measurement. Manufactured in accordance with **BS 891 : 1962 & IS 3804 : 1966**.

Measuring ranges:

- 20-88HRA (Test force: 588.4N/60kgf),
- 20-100HRB (Test force: 980.7N/100kgf),
- 20-70HRC (Test force: 1471N/150kgf).

Max height of test piece: 80mm with screw protective jacket, 170mm without.

Depth of throat: 135mm.

Dimensions: 466 x 238 x 630mm.



Model Number	Weight each	Order Code
150R	65kg	OXD-303 -1000K

Anvils, Indentors & Test Blocks

To suit Oxford hardness tester.

Large Flat Anvil



Small Flat Anvil



V-Notch Anvil

Test Block



Steel Ball Bearing Indentor



Diamond Indentor

Description	Size	Order Code
Large Flat Anvil	150mm	-9100K
Small Flat Anvil	58mm	-9110K
V-Notch Anvil	-	-9120K
Diamond Indentor	ø1.588mm	-9150K
Steel Ball Bearing Indentor	ø1.588mm	-9160K
Rockwell Std. Test Block	80 HRA	-9200K
Rockwell Std. Test Block	85 HRB	-9210K
Rockwell Std. Test Block	60 HRC	-9220K
Rockwell Std. Test Block	35 HRC	-9230K
Rockwell Std. Test Block	20 HRC	-9240K

PRODUCTS ARE ONLY AVAILABLE VIA YOUR DISTRIBUTOR

GROUP 306 GRANITE VEE BLOCKS, SQUARES & SURFACE PLATES

OXFORD *Oxford*
PRECISION *Granite*

Precision granite products are manufactured to the highest quality standards to provide an accurate surface from which final measurements can be taken. More dimensionally stable than steel or cast iron, with a low thermal expansion co-efficient. Does not burr, is corrosion free and easy to maintain.

Straight Edges

Used for checking surfaces for straightness, drawing and scribing straight lines. Manufactured to **BS5204 : Part 2 : Grade A**. Supplied with calibration certificate.



L x W x H	Weight each	Order Code
630 x 100 x 35mm	7kg	-6020K
1000 x 160 x 50mm	10kg	-6040K

Parallels

Used for setting up work on machine tables and surface plates. Sold in pairs.

Manufactured to **BS906 : Part 1 : Grade B** for flatness and parallelism of working faces. Supplied with **UKAS** certificate.



L x W x H	Weight each	Order Code	Price/Pr
160 x 25 x 16mm	0.55kg	-3020K	
250 x 40 x 25mm	1.83kg	-3040K	
400 x 63 x 40mm	6.97kg	-3060K	

Vee Blocks

90°. Used for handling and inspecting round work. Also used for layout work. Sold in pairs. Manufactured to **BS3731 : Grade 2**. Supplied with **UKAS** certificate.



L x W x H	Weight each	Order Code	Price/Pr
62 x 62 x 62mm	2.0kg	-7020K	

Surface Plates

Accurate bases which are used for mounting sensitive measuring, mechanical and electronic equipment. Manufactured to **BS817**. Supplied with calibration certificate.



Grade 1 - Inspection Grade

L x W x H	Weight each	Order Code
400 x 250 x 70mm	27kg	-4020K
630 x 400 x 100mm	90kg	-4040K
800 x 500 x 100mm	140kg	-4060K
800 x 500 x Stand	20kg	-4100K

Squares

90°. For measuring and inspecting squareness, parallelism and alignment. Manufactured to **BS939 : 1977 Grade A** for flatness, straightness and squareness of working faces. Supplied with **UKAS** certificate.



L x W x H	Weight each	Order Code
250 x 160mm	2.26kg	-5060K

EDISON *Infrared Laser Thermometer*

A high resolution infrared laser thermometer suitable for a wide range of industrial applications, HVAC and automotive diagnostics. The laser targeting enables accurate readings by guiding the user to the optimum measuring distance. Ideally suited for work in confined spaces and where accuracy is required such as on circuit boards, air-con units or in engine compartments. Simply aim at the target object, pull the trigger mechanism and read the current surface temperature from the LCD display. If necessary the laser can be activated via the laser button for more accurate targetting. Temperature is displayed on back-lit LCD display and features hold function for ease of use.

Measurement range: -20C to 537C.
Accuracy: -20C to 50C /- 2.5C 51C to 537C /- (Reading x 1% 1C)
D/S ratio: 12:1. **Emissivity:** 0.95.
 Celsius/Fahrenheit display selection.
 Back light display.
Power source: 9V battery
 Average/maximum/minimum/maximum-minimum mode selection.
Complies with:
 EN61326:1997/A1:1998/A2:2001/A3:2003
Dimensions (L x W x H): 162 x 56 x 190mm
Nett weight: 270g



Precision & Laboratory Equipment

Description	Order Code
Infrared Thermometer	EDI-312 -4000K

RUTLAND *Multi Function Digital Stopwatch - Standard*

Water and shock resistant design. Supplied with nylon neck cord.

Specification:
 1/100 second precision with split times. Calendar and time display 12hr or 24hr format. Daily alarm. Hourly chime. Supplied complete with 1.5V battery.



Order Code
RTL-314
-3020K

Multi Function Digital Stopwatch - Professional

Water and shock resistant design, slim line contour case fits comfortably in the hand. Supplied with nylon neck cord.

Specification:
 1/100 second precision with split times. Calendar and time display 12hr or 24hr format. Fastest, slowest and average lap calculation. Daily alarm. Hourly chime. Supplied complete with 1.5V battery.



Order Code
RTL-314
-3040K

OXFORD *Mechanical Stroke Counter*

Five digit mid-range mechanical stroke counter. Tough plastic case. Excellent value.

Overall length: 80mm.
 Height: 30mm.



Spindle Rotation	Order Code
Right Hand	OXD-314 -6100K

Chrome Tally Counters

Four digit (0-9999) metal body mechanical counters with push button actuator and reset button. Sturdy chrome plated steel construction.

Hand Tally comfortably fits in the palm of your hand, audible click, finger ring and recommended for applications where operator must be mobile. >



< **Desk Tally** features a special mounting base designed for desk, bench or clipboard mounting. Recommended for fixed applications.

Description	Order Code
Hand Tally	-5500K
Desk Tally	-5520K

Electronic Tally Counter - Up

Electronic tally counter counts up to 9999. Four-digit LCD with large push-buttons. High-impact construction with comfortable rubber keys. Optional audible counting indicator. Battery included.
 Dimensions
 W x D x H:
 30 x 15 x 60mm.



Model No	Type	Weight each	Order Code
EC2	Up only	17g	-5820K
EC3	Up/Down	17g	-5830K

OXFORD Precision Dial Indicating Bore Gauges

29mm 1 1/8" Dial Diameter

Suitable for rapid, accurate measurement of size, concentricity, wear, taper, etc., in a wide range of bores. For workshop and inspection use. All models have one fixed and one moving anvil and a self-adjusting centre shoe.

A 'datum point' can be set by using a setting ring of a known diameter or a micrometer. 'Zero' the gauge to this datum point by rotating the bezel to align 'zero' with the indicator.

To check a bore is within tolerance, the limit hands can be fixed as required. All anvils are spring loaded to expand into the bore.

For accurate reading ensure the stem of the gauge is parallel to the axis of the bore.

This can be checked by 'rocking' the gauge back and forth until the smallest diameter is found. All models have interchangeable anvils to cover a range of bore sizes.



Supplied in a tough hard case

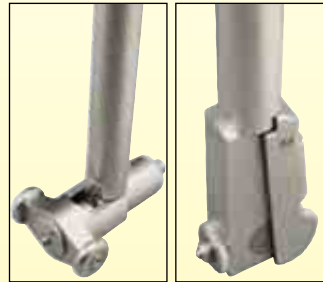

Type	Graduation	Face Dial	Reading	Travel Per Rev	Total Travel
Metric	0.01mm	57mm	0-100	1mm	3mm
Inch	0.0005"	2 3/16"	0-25-0	0.050"	0.25"

Range	Bore Depth	Weight each	Order Code
18-35	200	0.58kg	-1400K
35-50	240	0.95kg	-1450K
50-150	240	1.28kg	-1500K
0.7-1.5"	7 1/2"	0.53kg	-1000K
1.4-2.4"	9"	0.90kg	-1050K
2.0-6.0"	9"	1.20kg	-1100K

Spare Anvils

To Suit Gauge Size	Order Code
18 - 35mm	-5100K
35 - 50mm	-5101K
50 - 160mm	-5102K

Folding Pocket Magnifiers

Although deriving its name from the textile industry it is also suitable for inspecting paper, photographs, printed documents etc. Self-standing to free your hands. Folds flat when not in use. Black powder coated body. The original 'Linen tester'.

15mm Diameter

15mm diameter glass lens. 7x magnification. 1" working distance. 1/2" square field. Inch graduation. 1/8" divisions.



30mm Diameter

30mm diameter glass lens. 6x magnification. 38mm (1 1/2") working distance. 25mm (1") square field. Metric and inch graduations. 1mm and 1/8" divisions. Complete with plastic wallet.



Diameter	Order Code
15mm	-1600K
30mm	-1620K

Magnifying Loupes

Suitable for precision engineers, instrument makers, watch repairers, jewellers etc.

Triplet

Provides sharp images with minimum distortion. Three separate lenses bonded together to form one compound lens. Chrome plated finish. Complete with leather case.



Doublet

21mm diameter double lenses bonded together to form one compound lens. Provides a sharp magnified image with virtually no distortion.



Type	Magnification	Order Code
Triplet	10x	-1500K
Doublet	20x	-1520K

LED Light Magnifier

10x magnification. 5mm diameter LED light. 30mm diameter integral 2x optical glass lens. Powered by 3x AAA batteries (not supplied). LED last around 40,000 hours under normal use. Battery life = 40/50 hours under continuous use. Compared to a conventional bulb the LED diode lives up to 1000 times longer with 90% less power consumption. Complete with plastic case with belt loop.



Diameter	Order Code
30mm	-2010K

Precision & Laboratory Equipment



OXFORD PRECISION Bench Magnifiers

89mm (3½") diameter lens. 2x magnification. Chrome plated brass frame. 180mm flexible hose length permits viewing at any angle. Suitable for viewing work requiring high precision, reading, sewing, quality control, hobbies etc.



With Clamp

Black powder coated clamp provides stability and convenience. Portable and easy to clip onto a bench or table. Clamping capacity: 55mm.

With Stand

Cast horseshoe type stand provides stability and convenience.



Type	Order Code
Clamp	-1100K
Stand	-1120K

Hand Magnifier

Available in 2x, 3x and 4x deluxe high power magnifications. 2x, 3x have chrome-plated brass frame and bakelite handle. 4x deluxe has a gilt-effect frame and hardwood handle. Suitable for reading, stamp and coin collection, product examination, etc.

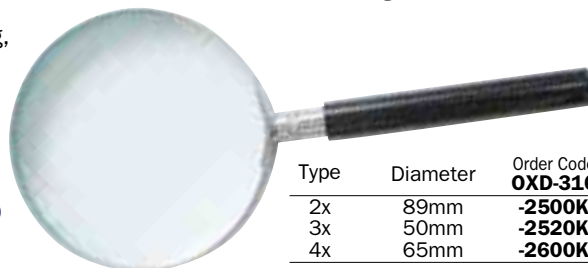

EXTENDED RANGE

Type	Diameter	Order Code
2x	89mm	-2500K
3x	50mm	-2520K
4x	65mm	-2600K

Illuminated Bench Magnifier - Adjustable Arm Type

Illuminated bench magnifier fitted with long life high efficiency 22W circular fluorescent daylight tube which provides perfect colour matching, low heat emission and greater eye comfort. Suitable for the workplace, hobbies or for people with limited vision.

- 127mm (5") diameter lens.
- 3x magnification.
- 1143mm (45") arm length.
- 180° arm adjustment.
- 160° lamp adjustment.

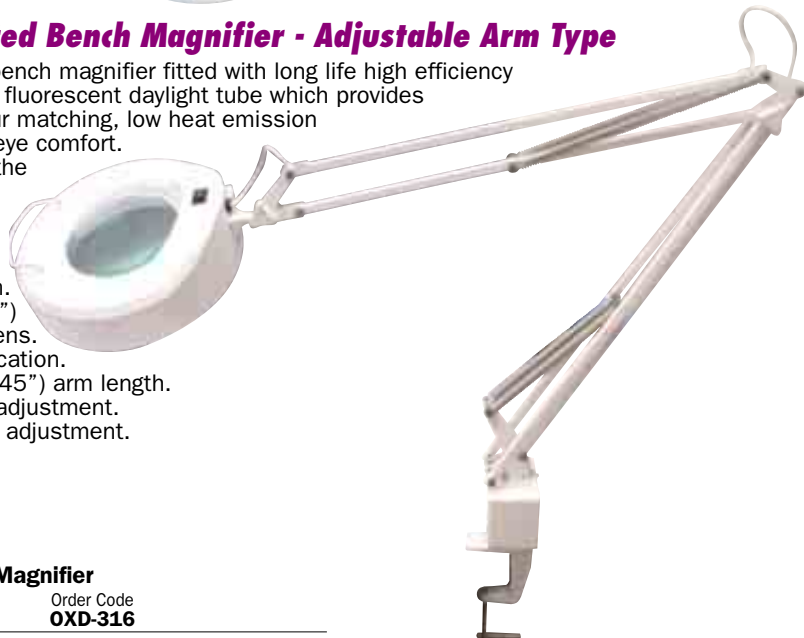

Illuminated Magnifier

Diameter	Order Code
127mm	-1030K

LED Head Loupe with removable LED light and interchangeable lenses

This head loupe has a detachable LED light which can be removed to provide an independent source of light that has two magnets for attaching to steel objects. It can be worn with spectacles and has an adjustable headband for greater comfort and integral visor to cut out ambient light. It comes with four interchangeable lenses supplied with their own storage case. The lenses stay firmly in position when raised or lowered, leaving both hands free to work. Suitable for electrical service and assembly, model making and other applications where both hands are required to carry out finely detailed work.



NEW

Contents:

- 1 x Head Loupe with removable LED light (batteries not incl.)
 - 1 x Blanking plate for Visor when LED is removed.
 - 1 x Box of four lenses:
- | Magnification | Working Distance |
|---------------|------------------|
| 1.2x | 520 - 620mm |
| 1.8x | 230 - 320mm |
| 2.5x | 150 - 250mm |
| 3.5x | 80 - 120mm |

Description	Order Code
LED Head Loupe	-2560K

Illuminated Adjustable Stand Magnifier

With the lens tilted, small hand-held objects can be worked on or inspected. When the lens is parallel to the work surface anything laid beneath is in focus. Fitted with a long life high efficiency 22W circular daylight tube which provides perfect colour matching, low heat emission and greater eye comfort. Suitable for the workplace, hobbies or for people with limited vision.

- 127mm (5") diameter lens.
- 3x magnification.
- Fully adjustable
- 220V.
- 170mm height adjustment.



Diameter	Order Code
127mm	-1010K

GROUP 318 BINOCULARS

RUTLAND III SPORT Compact Style Binoculars

Compact folding design for easy storage and transport. The high quality roof prisms and UV protective coated ocular lenses are housed in a polyurethane body coated in a shock absorbing high grip rubber armour. Diopter adjustment for improved image clarity and sharpness. To allow use with spectacles the soft rubber eye cups fold down. Accurate focusing of the binoculars is controlled by fingertip movement of the central focusing wheel. Integral neck strap eyelets and tripod mounting threaded recess point. Supplied complete with neck strap and cleaning cloth. Suitable for camping/hiking, outdoor spectator sports, nature viewing, theatre. Lead- and arsenic-free glass.



8 x 21

CR0821



10 x 25

CR1025



CR1025R

10 x 25

NEW

Diopter measurement



Product Number	Magnification	Order Code
CR1025R	10 x 25	-1620K

Fold down eye cup



Diopter measurement



Product Number	Magnification	Order Code
CR0821	8 x 21	-1120K

Fold down eye cup



Diopter measurement

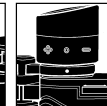

Product Number	Magnification	Order Code
CR1025	10 x 25	-1230K

RUTLAND III SPORT Ultra Compact Binoculars

The ultra compact design makes them ideal for use when storage space is at a premium. The high quality porro prism coated lenses are housed in a tough polyurethane body which is comfortable to hold. The diopter adjustment is easy to use and improves the image clarity and sharpness. Simple yet accurate focusing is achieved using fingertip control of the central focusing wheel. Supplied complete with case, neck strap and cleaning cloth.



NEW

8 x 21

Diopter measurement



Product Number	Magnification	Order Code
CP0821	8 x 21	-1660K

Traditional Style Binoculars

The high quality porro prisms and UV protecting ruby coated ocular lenses are housed in a polyurethane body coated in a shock absorbing high grip rubber armour. Diopter adjustment for improved image clarity and sharpness. To allow use with spectacles the soft rubber eye cups fold down. Accurate focusing of the binoculars is controlled by fingertip movement of the central focusing wheel. Integral neck strap eyelets and tripod mounting threaded recess point. Supplied complete with lens cap, case, neck strap, and cleaning cloth. Suitable for camping/hiking, outdoor spectator sports, nature viewing. Lead- and arsenic-free glass.

10 x 50



Pupil distance scale



Tripod use



Fold down eye cup



Diopter measurement



Product Number	Magnification	Order Code
TP1050	10 x 50	-1010K



Traditional Binoculars 7 x 50

Model TP0750

High quality lenses. Ocular objective lens caps. Diopter adjustment ring with index. Neck strap eyelets underneath. Central focusing wheel, tripod mounting with thread cover. Comfortable ergonomic design. Rubber armoured grip. Tripod mounting point.

Includes

Lens caps, case, neck strap, and cleaning cloth.

7 x 50



TP0750

Prism type: Porro
Magnification: 7x
Objective lens: 50mm
Angle of view: 6.8°
Field of view at 1000m: 119m
Exit pupil: 7mm
Focusing method: Manual
Closest focusing distance: 9m
Dimensions: (W x H x D)
 176 x 191 x 82mm
Weight: 900g

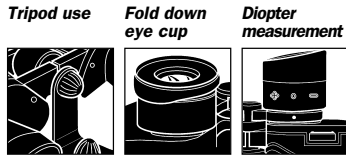

Product Number	Magnification x Lens Diameter	Order Code
TP0750	7 x 50	-1370K

Traditional Binoculars 10 x 42

Model TP1042

These Rutland Pro binoculars have a powerful 10 x magnification using a Porro prism, a 6° wide angle of view and a 42mm objective lens. These binoculars are powerful, yet have a narrow pupil distance making them ideal for the smaller user. The outer casing of the binoculars is designed for your comfort and covered with a protective rubber coating, to prevent damage from the occasional bump that may occur whilst in use. The point of focus is smoothly controlled with the central focusing wheel.

Includes

Lens caps, case, neck strap, and cleaning cloth.

NEW



TP1042

10 x 42

Prism type: Porro
Magnification: 10x
Objective lens: 42mm
Angle of view: 6°
Field of view at 1000m: 105m
Exit pupil: 4.2mm
Focusing method: Manual
Closest focusing distance: 4m
Dimensions: (W x H x D)
 110 x 168 x 65mm
Weight: 775g

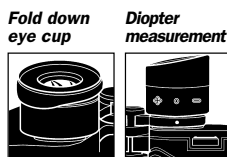

Product Number	Magnification x Lens Diameter	Order Code
TP1042	10 x 42	-1600K

Traditional Binoculars 10 x 60

Model TP1060

Ruby coated high quality precision lenses. Double diopter adjustment ring with index. Neck strap eyelets. Ocular lens caps. Central focusing wheel, tripod mounting thread cover. Objective lens caps. Rubber armoured ergonomically designed grip. Tripod mounting point.

Includes

Lens caps, case, neck strap, and cleaning cloth.

10 x 60



TP1060

Prism type: Porro
Magnification: 10x
Objective lens: 60mm
Angle of view: 6.4°
Field of view at 1000m: 108m
Exit pupil: 6mm
Focusing method: Manual
Closest focusing distance: 10m
Dimensions: (W x H x D)
 200 x 200 x 85mm
Weight: 1175g

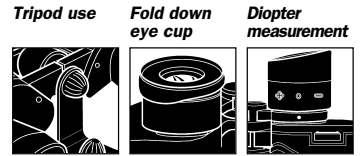

Product Number	Magnification x Lens Diameter	Order Code
TP1060	10 x 60	-1400K

Spotting Scope 18-36 x 50

Model SS3650

High quality precision lenses. Dust caps for ocular and objective lenses. Rubber armoured body protection. Complete with tripod and mounting point. Includes case with shoulder strap, and cleaning cloth. Bag has integral divider which separates the scope from the tripod to eliminate undue wear and tear.



SS3650

18 - 36 x 50

Prism type: Porro
Magnification: 18 - 36x
Objective lens: 50mm
Angle of view: 26 - 43°
Field of view at 1000m: 23 - 38m

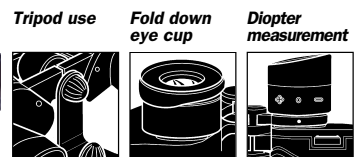

Exit pupil: 1.5 - 4mm
Focusing method: Manual
Dimensions: (W x H x D)
 380 x 360 x 330mm
Weight: 1190g

Product Number	Magnification x Lens Diameter	Order Code
SS3650	18-36 x 50	-3100K



BCM400

Constructed to high optical and mechanical standards, the Oxford Biological Compound Microscope produces a clear and well defined two dimensional image.

- Designed for clinical examination and teaching demonstrations in laboratories, scientific research, colleges and the medical field.
- An ideal instrument for biological, bacteriological, pathological and pharmaceutical research.
- High quality prism providing a magnification of up to 400x.
- Fully coated optical system for improved light transmission and overall image quality.
- Objective lenses are of DIN standard, colour coded and click into position.
- Eyepiece with pointer.
- Monocular head which is inclined at 45° and can be rotated 360°.
- Separate fine and coarse focus by rack and pinion with a built-in slip clutch and tension adjustment.
- Built in illuminator with a blue filter and a built in condenser lens ensuring optimal light effect for comfortable and clear viewing.
- Large die cast acid and reagent proof stage.

Model number: BCM400
Order Code: OXD-318-4100K
Eyepiece: Wide angle 10x, 18mm field with pointer
Tube length: 160mm
Objective lenses: Achromatic DIN 4x (0.10 numerical aperture)
Objective lenses: Achromatic DIN 10x (0.25 numerical aperture)
Objective lenses: Achromatic DIN 40xS (0.65 numerical aperture) retractable
Disc diaphragm: 3mm, 4mm, 5mm, 8mm and 20mm calibrated dish type
Stage condenser: Single lens 0.65 numerical aperture condenser
Fine focusing: 0.0002mm
Stage: 110 x 120mm
Lamp: 220V/20W tungsten bulb
Fuse type: Lamp T1A 250V, plug 3 amp
Voltage: 220V ± 10%, 50/60Hz
Indoor working temperature: 0°C - 40°C (32°F - 104°F)
Maximum relative humidity: 85%
Overall height: 355mm
Net weight: 2.832kg

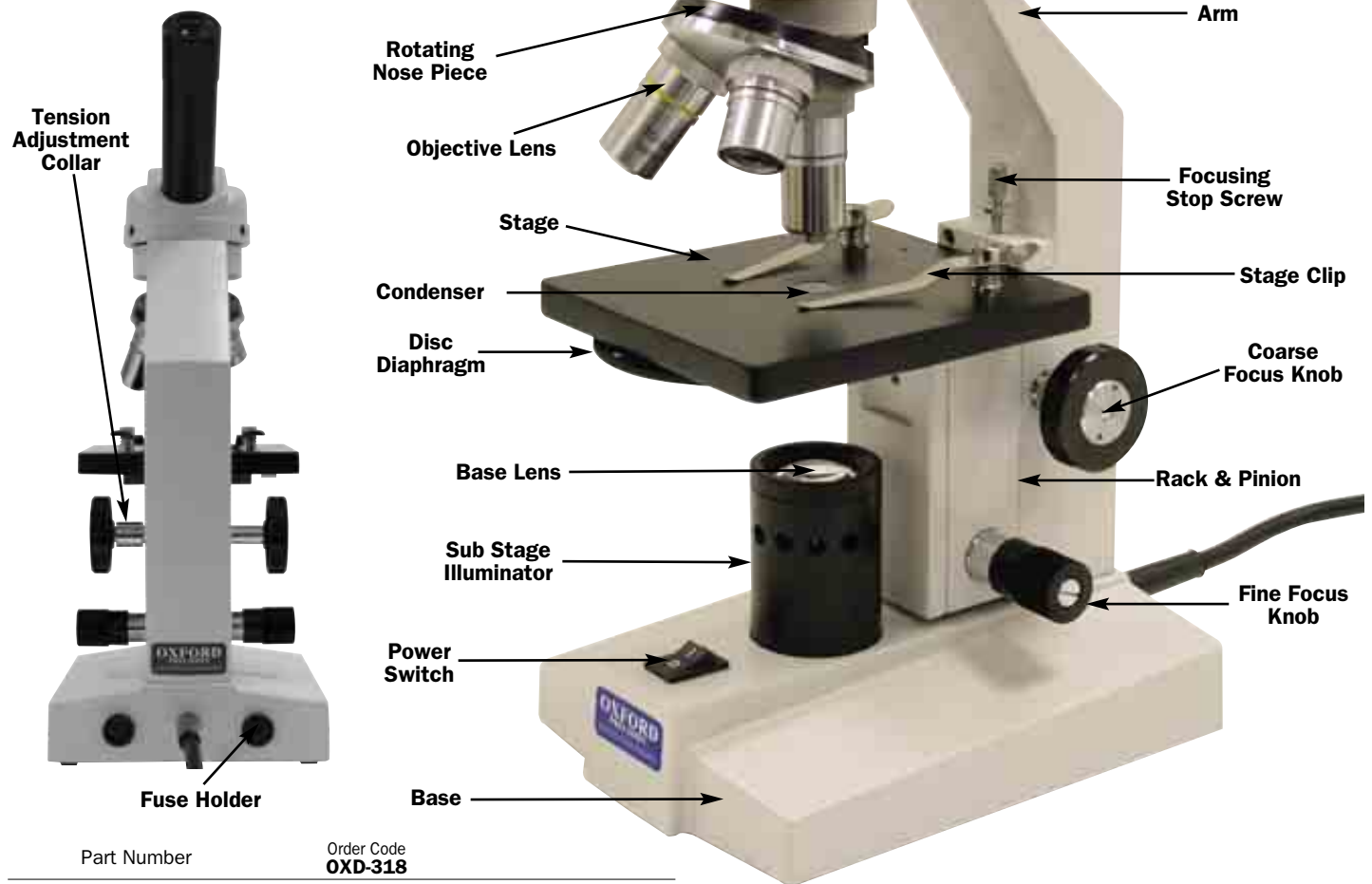

Part Number	Order Code
BCM400	OXD-318-4100K

Accessory	
Description	Order Code
Slide	OXD-398-5330K



OXFORD PRECISION *Dissecting Stereo Metallurgical Microscope*

Precision & Laboratory Equipment

DSM040:

Constructed to high optical and mechanical standards, the Oxford Dissecting Stereo Microscope produces a clear and well defined three dimensional image.

- Designed for clinical examination and teaching demonstrations in laboratories, scientific research, colleges and the medical field.
- Provides true colour.
- High quality prism providing a magnification of up to 40x.
- Fully coated optical system for improved light transmission and overall image quality.
- Objective lenses are of DIN standard and click into position.
- Rubber eyecups and a diopter adjustment ring for clear and comfortable viewing.
- Rack and pinion focusing with built in slip clutch system.
- A choice of either upper or lower illumination or both.
- Pillar mounted body rotates 360° and can be removed and mounted on machine tools or laboratory apparatus.
- Binocular head which is inclined at 45°.
- Built in illuminator.

Model number: DSM040
Order Code: OXD-318-4400K
Eyepiece: Wide angle 10x
Field of view: 10mm at 2x/5mm at 4x
Diopter adjustment range: . . . ±5mm
Objective lenses: Achromatic DIN 2x/object field 10mm
Objective lenses: Achromatic DIN 4x /object field 5mm
Working distance: 53mm
Interpupillary distance: Adjustable between 55 - 75mm
Object plate: 95mm black/white and opaque glass
Lamp: 12V/10W festoon incandescent clear bulb
Fuse type: Lamp T1A 250V, plug 3 amp
Voltage: 220V ± 10%, 50/60Hz
Indoor working temperature: . . 0°C - 40°C (32°F - 104°F)
Maximum relative humidity: . . 85%
Overall height: 355mm
Net weight: 2.359kg

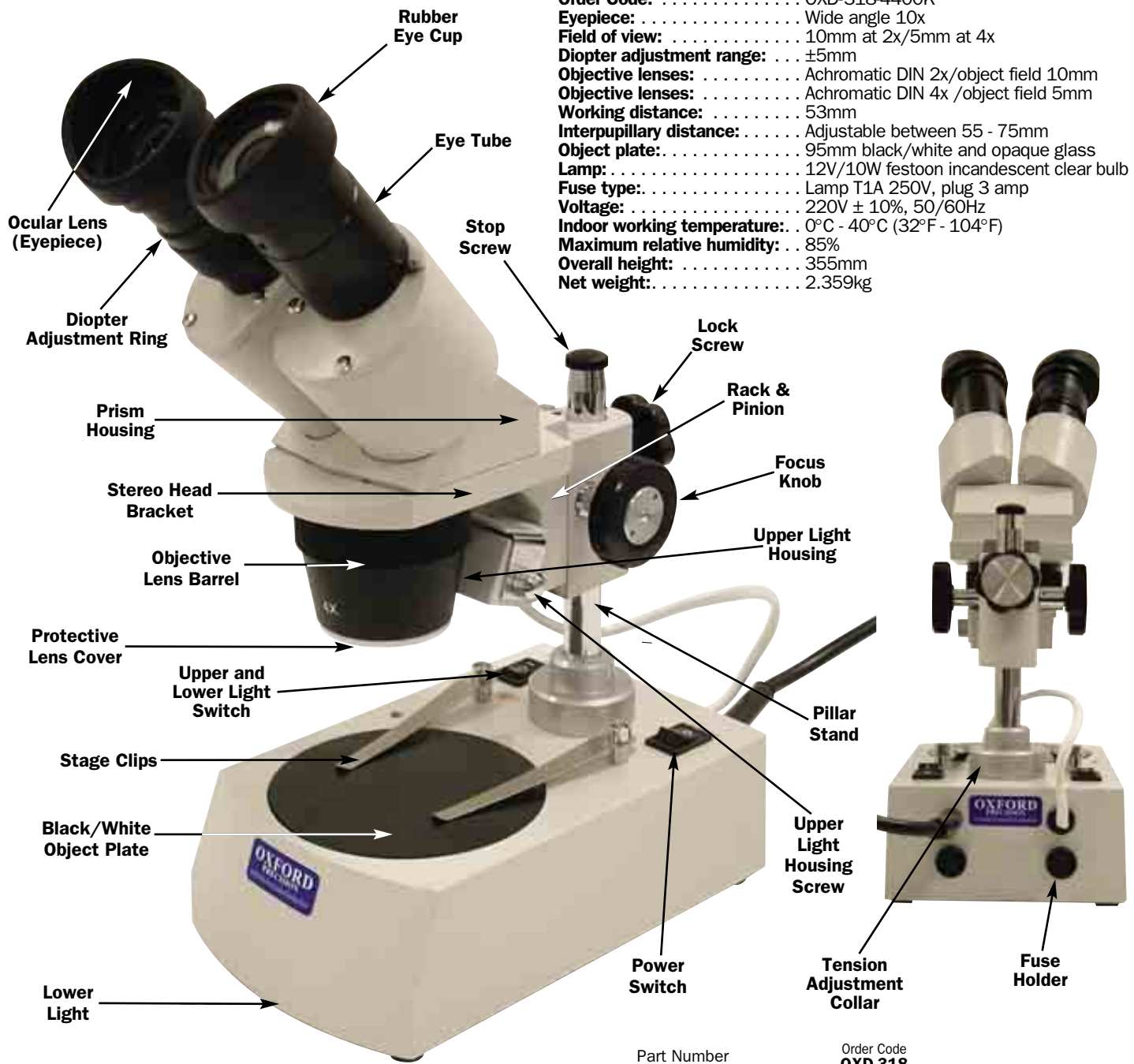

Part Number	Order Code
DSM040	OXD-318-4400K

Accessories

Description	Order Code
Slides	OXD-398
Microscope Bulb	-5300K -5320K

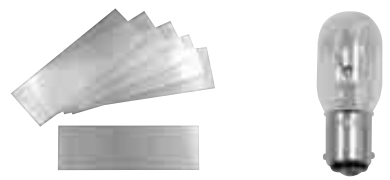

PRODUCTS ARE ONLY AVAILABLE VIA YOUR DISTRIBUTOR

OXFORD Precision Dual Counter Height Gauges

Used in conjunction with a granite or metal surface plate, the Oxford dual counter height gauge will give you the accuracy you need when laying out work prior to machining. The height gauge can also be used in much the same way as a caliper to help you determine the dimensions of a workpiece.

- Designed for accurate marking out and taking precise measurements.
- Measuring head positioned on sturdy twin columns providing highly repeatable height measurements and stability.
- Easy reading with dual directional negative and positive reading mechanical digital counters.
- Rotating dial face.
- Independently set the counters, to zero at any position.
- Large feed wheel for rapid and precise adjustment.
- Tungsten carbide tipped scriber for accurate marking out.
- Manufactured from durable stainless steel.



Reading
Inch: 0.001"/0.1"
Metric: 0.01mm/1mm



Range	Product Number	Range/Rev	Weight each	Order Code
12"	DHG000	0.1in	4.25kg	-3120K
24"	DHG000	0.1in	10kg	-3240K
300mm	DHG000	1mm	4.25kg	-3620K
600mm	DHG000	1mm	10kg	-3740K

Leg Type Dial Calipers

Leg type dial calipers used for measuring diameters and narrow grooves in hard to reach places.

Internal specifications: range: 55 - 75mm, graduation: .01mm, groove depth: 8mm, groove width: 3mm, maximum reach: 100mm.

External specifications: range: 0 - 20mm, graduation: 0.01mm, groove depth: 6mm, groove width: 3mm, throat depth: 60mm.

Type	Groove Depth	Reach/Depth	Weight each	Order Code
External	6mm	60mm		-0600K
Internal	8mm	100mm		-0750K



Dial Thickness Gauge

For quickly measuring the thickness of paper, film, leather, rubber etc. The spindle is moved using the thumb lever. With adjustable bezel. Measuring faces are made of high grade tool steel, hardened, ground and lapped for accuracy. Thumb lever raises spindle to allow for workpiece insertion.

- Specifications:**
Range: 0 - 10mm.
Graduations: 0.01mm.
Throat depth: 30mm.



Type	Groove Depth	Reach/Depth	Weight each	Order Code
External	6mm	60mm	236g	-0100K

KENNEDY Pocket Type Dial Thickness Gauges

Designed for carrying convenience. Lightweight - metric only 68g and inch 98g. Supplied in leather wallet.

- Spindle diameter:** 6mm flat.
Anvil diameter: 6.5mm flat.
Parallelism: 5µm or less.

Conversion chart printed on back of gauge.



Range	Graduation	Throat	Weight each	Order Code
0-10mm	0.01mm	19mm	136g	-4020K



KENNEDY *Combination Set*
QUALITY INDUSTRIAL TOOLING

Multi-function, can be used as a square, mitre, depth and height gauge. Each set consists of rule, square head, centre head, and protractor.

Square head: with accurate machined faces, fixed angles of 45° and 90°, built-in spirit level, adjusting nut and scriber.

Protractor head: for measuring angles up to 180°, graduated to 1° with one machined face, three knurled securing/adjusting nuts and built-in spirit level.

Centre head: for locating the centre of round bars, with a fixed angle of 90° and two accurately machined internal surfaces.

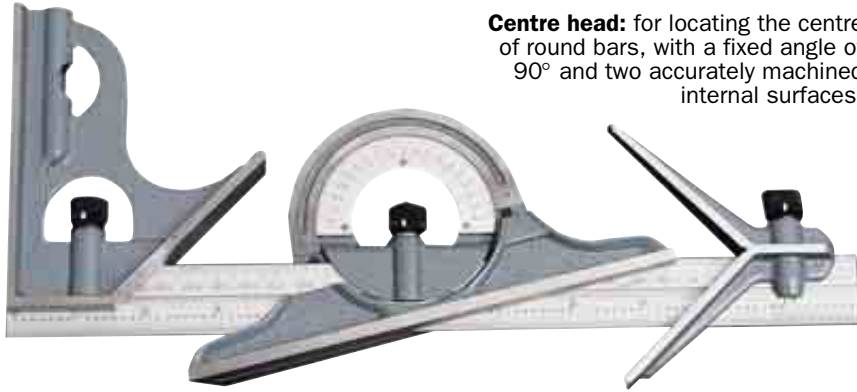

Rule: 300mm/12" hardened stainless steel, metric and inch measurements with graduations in 0.5mm and 1/64".

Typical Applications:

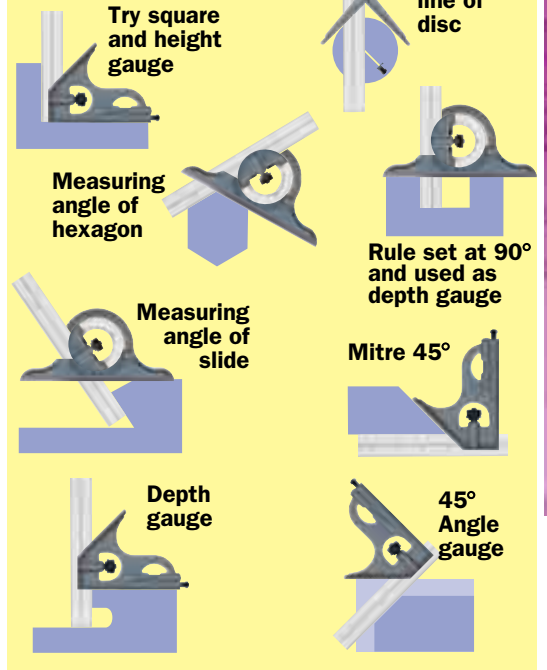

Combination Sets & Rules

Type	Weight each	Order Code
Combi set with 300mm/12" rule	890g	-3040K
Replacement 300mm/12" rule	110g	-3120K
Optional 600mm/24" rule	220g	-3240K

Description	Weight each	Order Code
Square Head, Level & Scriber	320g	-3070K
Centre Head with Lock Nut	190g	-3080K
Protractor Head Graduated 0 - 180°	490g	-3090K

How to Read a Universal Bevel Protractor

Whole numbers of degrees can be read by simply taking readings with the zero line on the vernier. Where this line coincides with a line on the main scale, an exact number of whole degrees is indicated. The vernier on a bevel protractor enables readings to be taken to five minutes or 1/12 of a degree. One division on the vernier is this amount shorter than the two divisions on the main scale.

If the zero line on the vernier does not coincide exactly with a line on the main scale, it is necessary to find the vernier line which does coincide with a main scale line; and this indicates the number of five minutes or 1/12 of a degree to be added to the whole of degrees. To take a reading, therefore, note the number of whole degrees, and then count in the same direction, the number of divisions on the vernier scale from the zero line to the first line on the vernier scale that coincides with a line on the main scale. As each of these is five minutes, multiply by five and the number of minutes to be added to the whole number of degrees will be indicated.

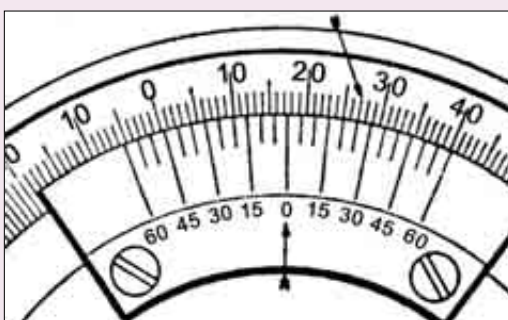
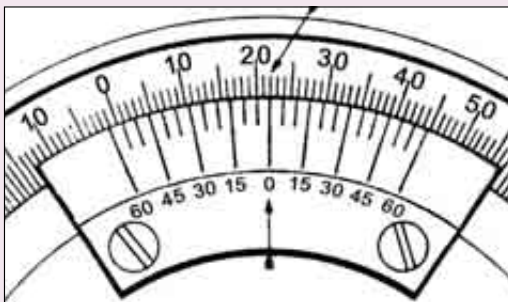

OXFORD *Vernier Bevel Protractor*
PRECISION

106UF

Suitable for measuring and marking out angles. Fully hardened and ground stainless steel. Bevelled blade ends. Scale plate is graduated 0 - 90° - 0, in both directions through 360°. Magnifying lens for easy reading of vernier scale to 5 minutes of degree (1/12th of a degree).



Blade Size	Weight each	Order Code
150mm		OXD-330 -9050K

Measuring Examples

External Dimensions

Put the workpiece as close to the reference surface as possible, and have the measuring faces firmly in contact with the workpiece without excessive force.



Internal Dimensions

For inside measurement, put the inside jaws as deep as possible and have the measuring faces firmly in contact with the workpiece without excessive force.

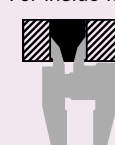

Depth Measurement

For depth measurement, set the depth bar perpendicular to the measured surfaces.

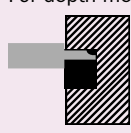

Step Measurement

For step measurement, have the step-measuring-faces firmly in contact with the workpiece.



OXFORD PRECISION Standard Vernier Calipers

Give four types of reading - inside, outside, depth and step. Dual reading scale (metric and inch) with 14° bevelled vernier scale for reduced parallax reading error and knurled locking nut. Manufactured from hardened stainless steel for rigidity. Satin finish. Conform to **DIN 862**.

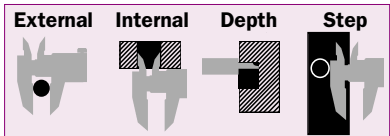
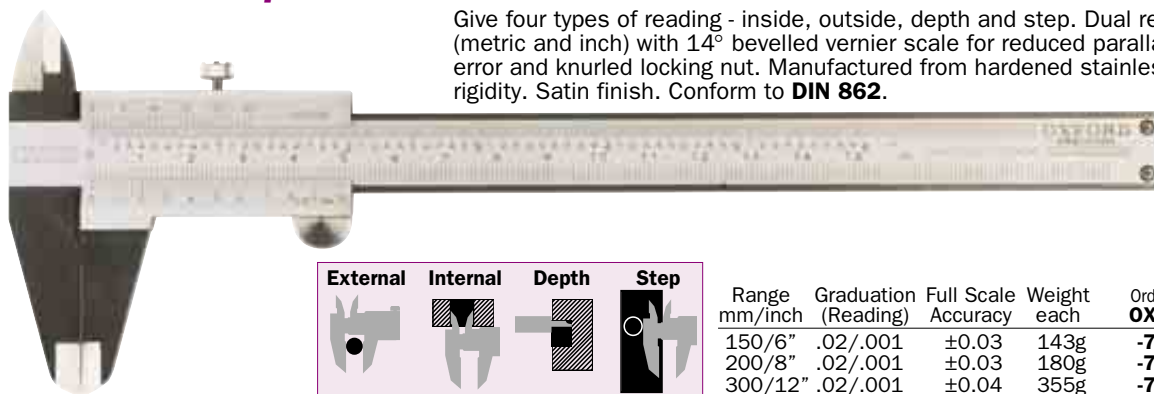

Range mm/inch	Graduation (Reading)	Full Scale Accuracy	Weight each	Order Code
150/6"	.02/.001	±0.03	143g	-7360K
200/8"	.02/.001	±0.03	180g	-7380K
300/12"	.02/.001	±0.04	355g	-7420K

Fine Adjustment Vernier Calipers

Give four types of reading, inside, outside, depth and step. Dual reading scale (metric and inch) with 14° bevelled vernier scale for reduced parallax reading error, fine adjustment assembly and knurled locking nut. Manufactured from hardened stainless steel for rigidity with satin finish. Conforms to **DIN 862**.

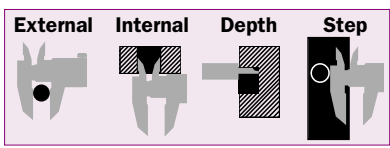
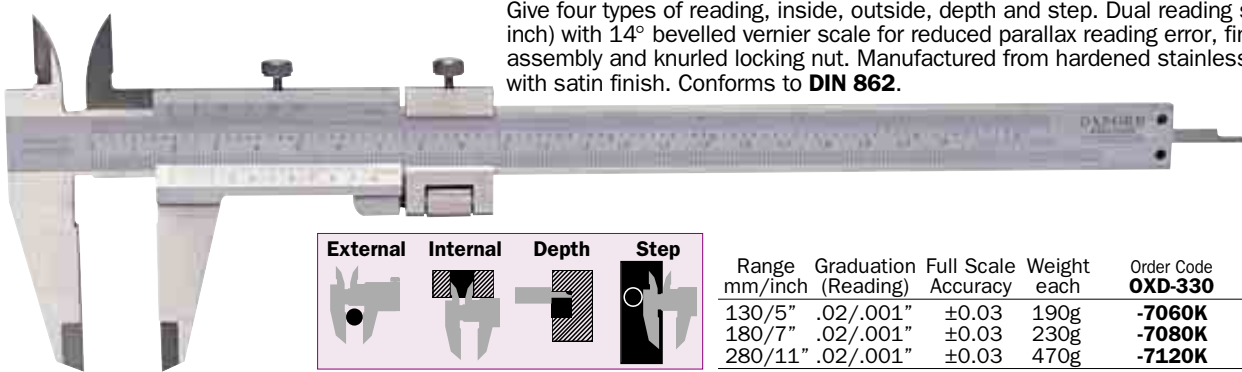

Range mm/inch	Graduation (Reading)	Full Scale Accuracy	Weight each	Order Code
130/5"	.02/.001"	±0.03	190g	-7060K
180/7"	.02/.001"	±0.03	230g	-7080K
280/11"	.02/.001"	±0.03	470g	-7120K

Heavy Duty Vernier Calipers

Give inside and outside readings. Dual reading scale (metric and inch) with 14° bevelled vernier scale for reduced parallax reading error, fine adjustment assembly and knurled locking nut. Internal reading edges have rounded faces for accurate bore measurement. Manufactured from hardened stainless steel.

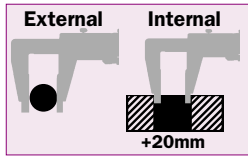
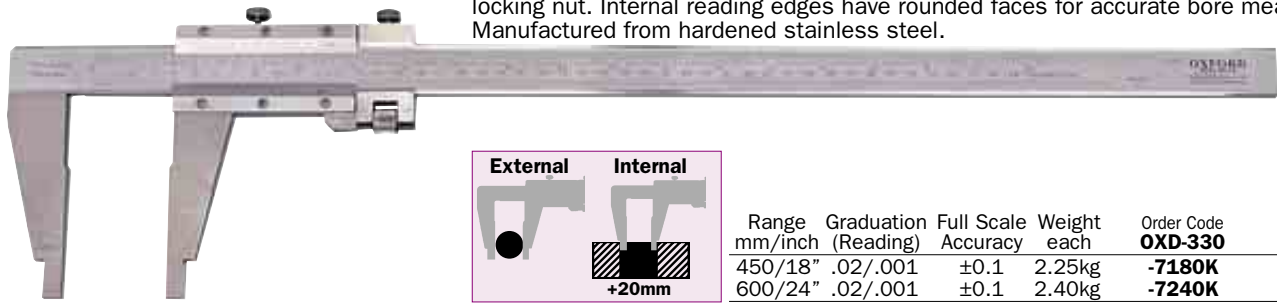

Range mm/inch	Graduation (Reading)	Full Scale Accuracy	Weight each	Order Code
450/18"	.02/.001	±0.1	2.25kg	-7180K
600/24"	.02/.001	±0.1	2.40kg	-7240K

KENNEDY QUALITY INDUSTRIAL TOOLING Fine Adjustment Vernier Calipers

Incorporating Quadri feature - gives outside, inside, depth and step readings. Fine adjustment feature allows improved sensitivity of slider movement. 14° vernier face angle reduces parallax. Satin chrome finish with clear easy read graduations.

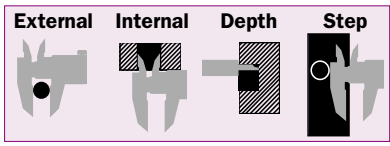
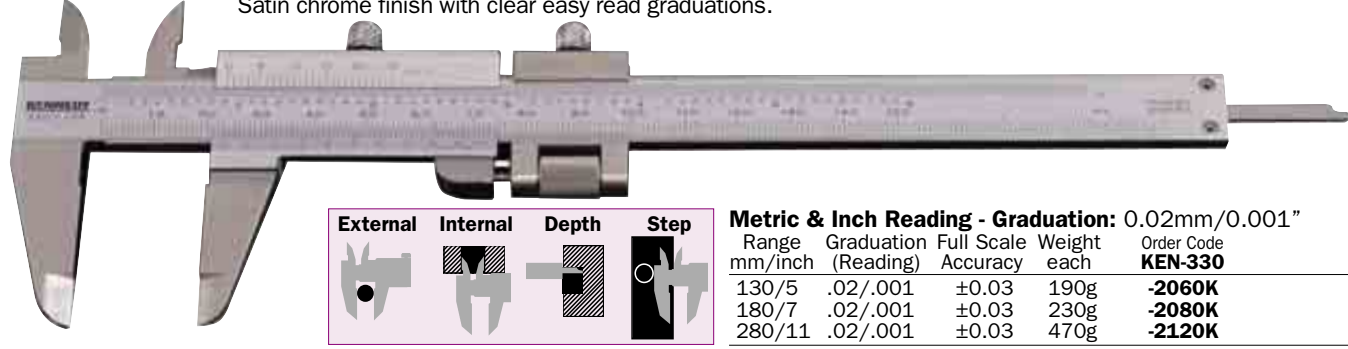

Metric & Inch Reading - Graduation: 0.02mm/0.001"

Range mm/inch	Graduation (Reading)	Full Scale Accuracy	Weight each	Order Code
130/5	.02/.001	±0.03	190g	-2060K
180/7	.02/.001	±0.03	230g	-2080K
280/11	.02/.001	±0.03	470g	-2120K

External Dimensions

Put the workpiece as close to the reference surface as possible, and have the measuring faces firmly in contact with the workpiece without excessive force.



Internal Dimensions

For inside measurement, put the inside jaws as deep as possible and have the measuring faces firmly in contact with the workpiece without excessive force.

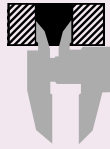

Measuring Examples

Depth Measurement

For depth measurement, set the depth bar perpendicular to the measured surfaces.

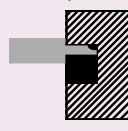

Step Measurement

For step measurement, have the step-measuring-faces firmly in contact with the workpiece.



SENATOR Dial Calipers - Plastic
QUALITY TOOLING

Accurate four way measurement: internal, external, step and depth. Sliding jaw lock. Manufactured from high strength, lightweight polyimide plastic.

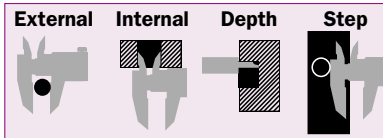
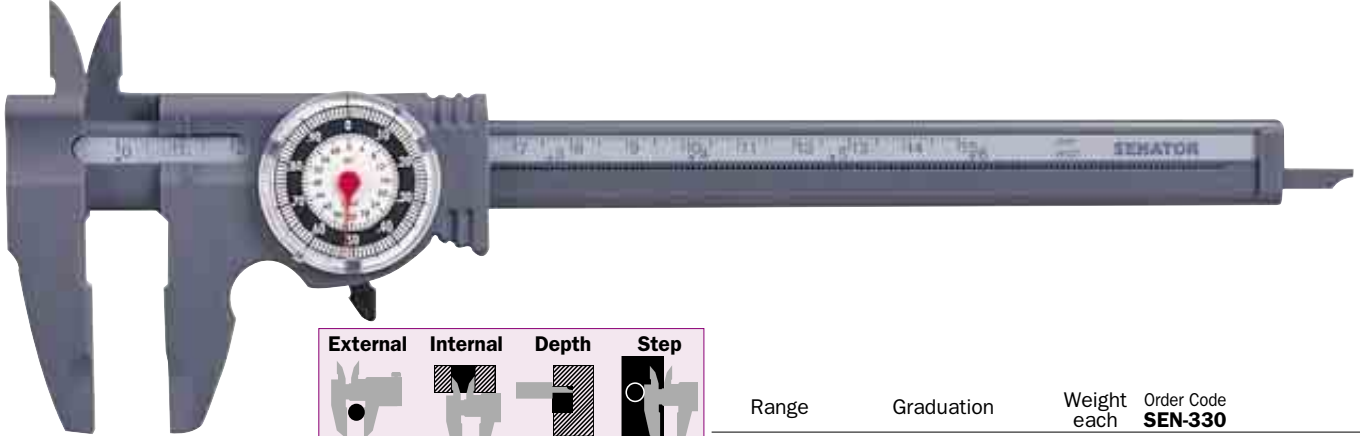

Range	Graduation	Weight each	Order Code
6"	0.01" / 1/64"	220g	SEN-330

OXFORD Dial Calipers
PRECISION

Rack covers prevent dust from fouling teeth of racks. All measuring faces are precision ground and micro lapped for absolute inside, outside, depth and step readings. Manufactured to **DIN 862**.

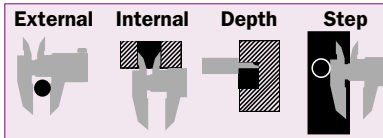
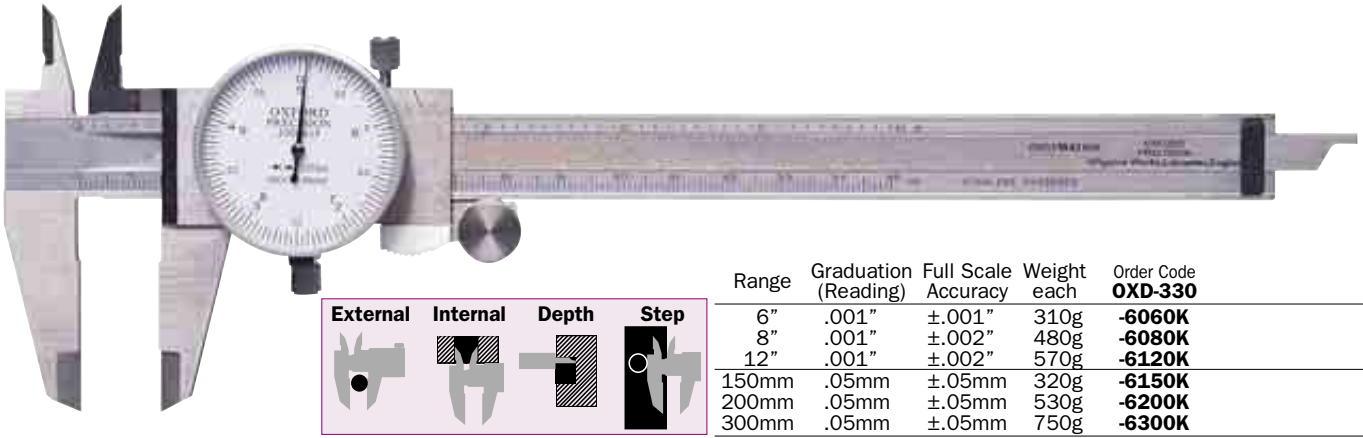

Range	Graduation (Reading)	Full Scale Accuracy	Weight each	Order Code
6"	.001"	±.001"	310g	-6060K
8"	.001"	±.002"	480g	-6080K
12"	.001"	±.002"	570g	-6120K
150mm	.05mm	±.05mm	320g	-6150K
200mm	.05mm	±.05mm	530g	-6200K
300mm	.05mm	±.05mm	750g	-6300K

KENNEDY Dial Calipers
QUALITY INDUSTRIAL TOOLING

Rack covers prevent dust from fouling teeth of racks. All measuring faces are precision ground and micro lapped for absolute inside, outside, depth and step readings. Manufactured to **DIN 862**.

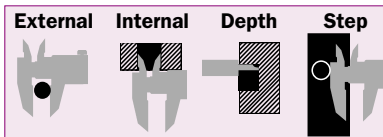
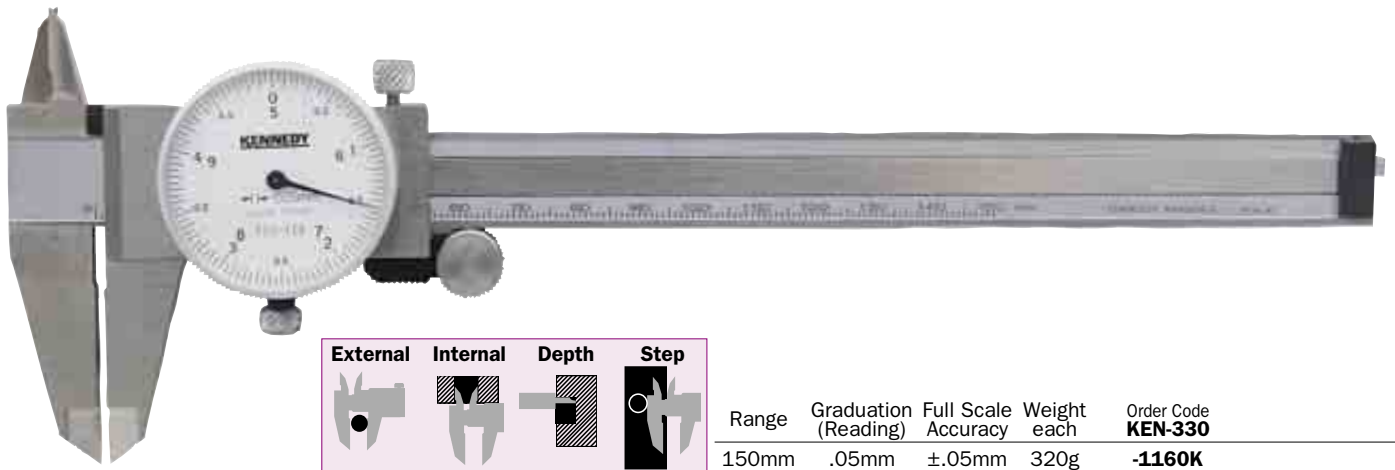

Range	Graduation (Reading)	Full Scale Accuracy	Weight each	Order Code
150mm	.05mm	±.05mm	320g	-1160K

PRODUCTS ARE ONLY AVAILABLE VIA YOUR DISTRIBUTOR

GROUP 331 DIGITAL CALIPERS

SENATOR Economy Digital Calipers

Suitable for taking inside and outside precision readings. Zero reset. Inch/metric conversion. Supplied with plastic case. Conforms to **DIN 862**. **Resolution 0.01mm/0.0005"**

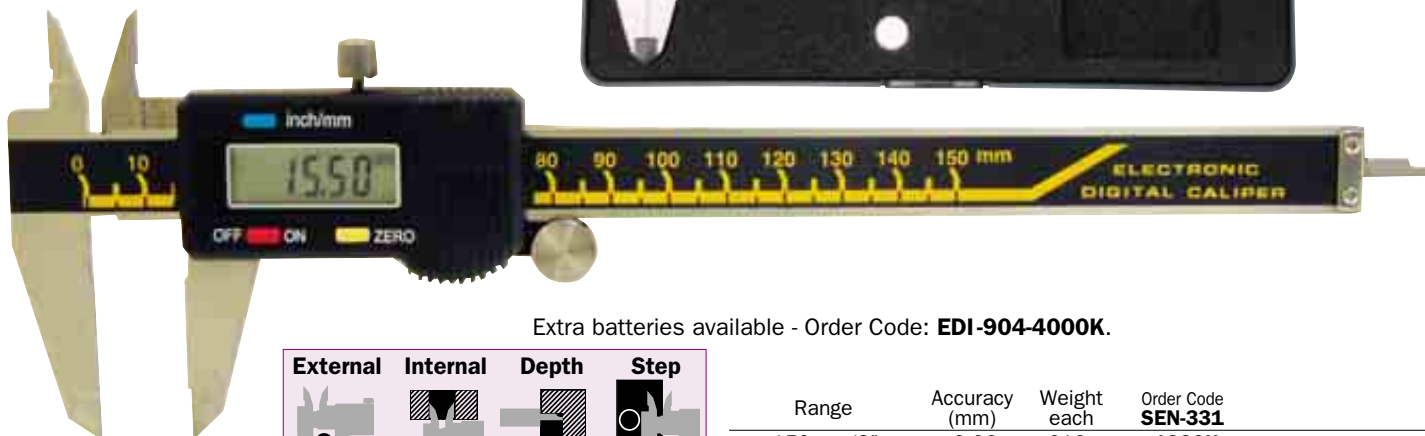
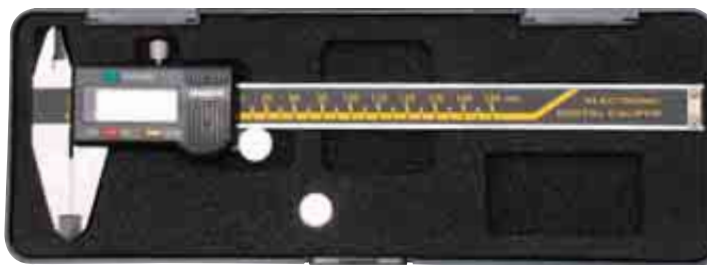

Extra batteries available - Order Code: **EDI-904-4000K**.

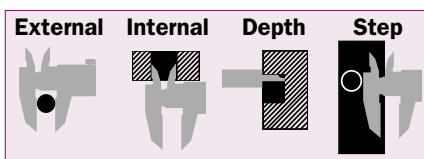

Range	Accuracy (mm)	Weight each	Order Code SEN-331
150mm/6"	±0.03	310g	-1330K
200mm/8"	±0.03	310g	-1360K
300mm/12"	±0.03	310g	-1400K

KENNEDY ABSolute Digital Electronic Calipers

Modern design with a knurled thumb wheel for easy use when taking internal and external depth and step measurements. Dual readout giving instant inch/metric conversion at the touch of a button. Zero reset at any point, large clear display, error-free operation, fast response speed.

Resolution 0.01mm/0.0005"

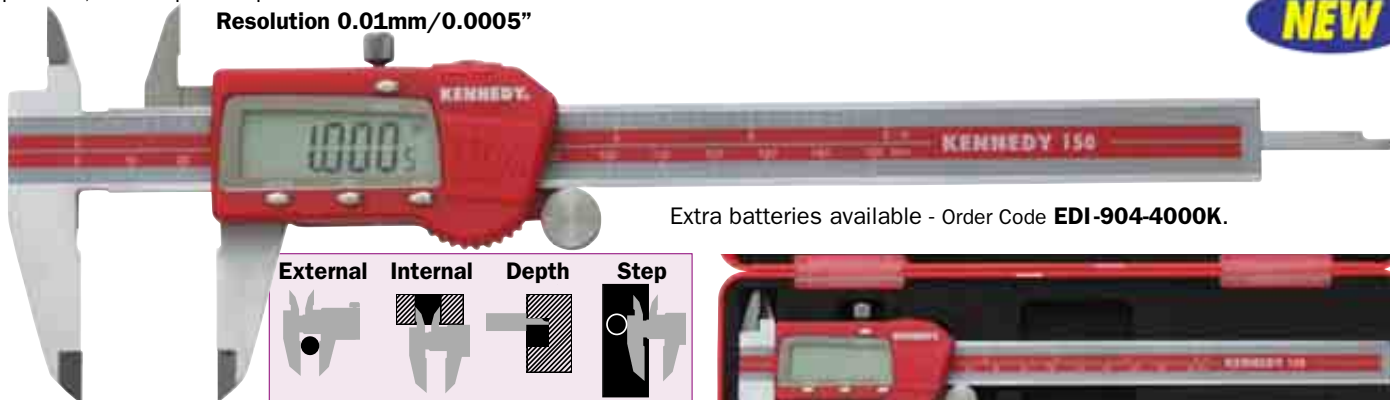

Extra batteries available - Order Code **EDI-904-4000K**.

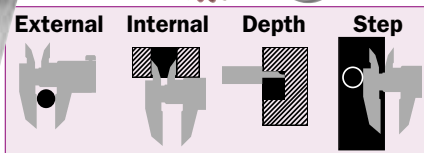

Range	Accuracy (mm)	Weight each	Order Code KEN-331
150mm/ 6"	±0.03		-2260K
200mm/ 8"	±0.03		-2280K
300mm/12"	±0.03		-2320K



ABSolute Calipers with SPC Output

With SPC data output (compatible with Mitutoyo SPC equipment), inch/metric conversion, on/off switch and zero set at any point. The absolute zero feature enables an (ABS) 'origin point' to be set anywhere within the measuring range.

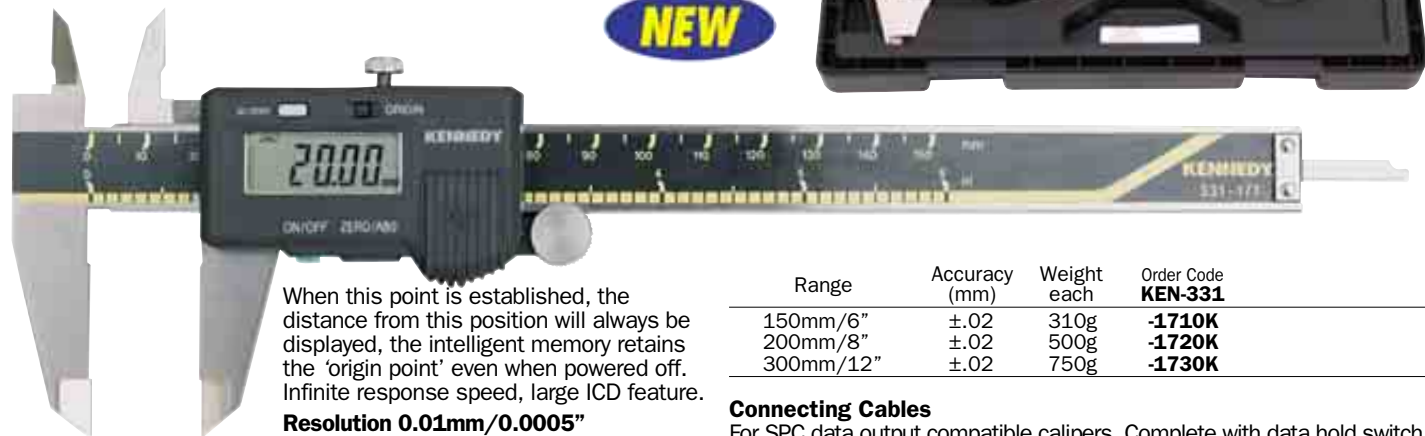

When this point is established, the distance from this position will always be displayed, the intelligent memory retains the 'origin point' even when powered off. Infinite response speed, large ICD feature.

Resolution 0.01mm/0.0005"

Range	Accuracy (mm)	Weight each	Order Code KEN-331
150mm/6"	±.02	310g	-1710K
200mm/8"	±.02	500g	-1720K
300mm/12"	±.02	750g	-1730K

Connecting Cables

For SPC data output compatible calipers. Complete with data hold switch.

Pin Type	Length	Weight each	Order Code KEN-331
Sub-D-Jack 9 Pin	1m	40g	-9010K
	2m	60g	-9020K



Extra batteries available - Order Code **EDI-904-4000K**.

PRODUCTS ARE ONLY AVAILABLE VIA YOUR DISTRIBUTOR



OXFORD PRECISION Precision ABS Digital Caliper

Precision ABSolute digital calipers have a thumb wheel for precise movement and a useful locking screw for checking repeat measurements. A measurement can be converted between inch/metric at the touch of a button.

ABSolute Measurement Function - The zero point once set is fixed until changed, even if the caliper is turned off (unless the battery is removed). Incremental mode can be achieved for repeated use of Go/No-Go measurement.

Resolution 0.01mm/0.0005"

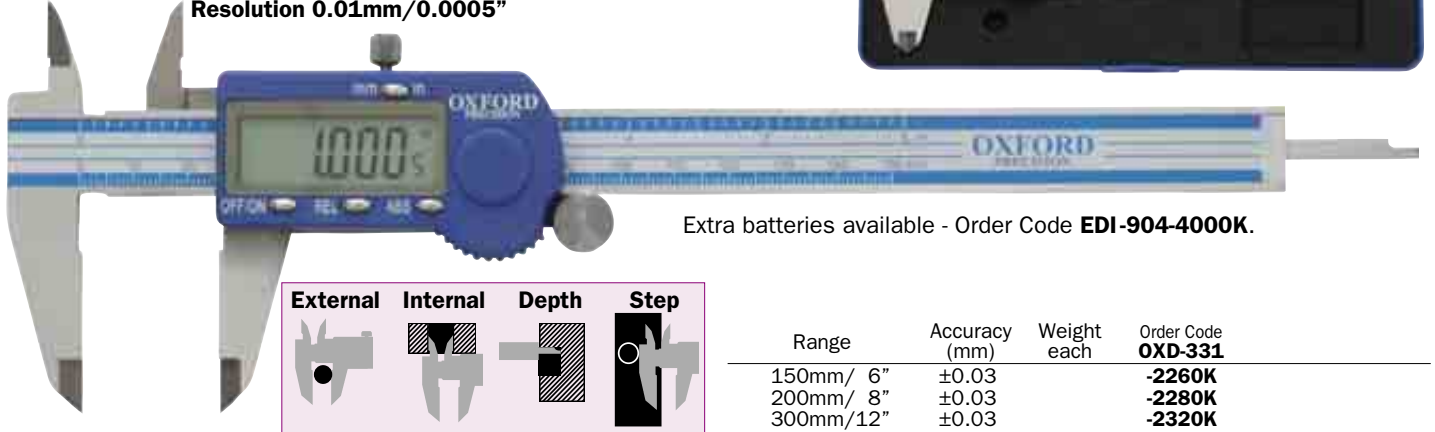

Extra batteries available - Order Code **EDI-904-4000K**.

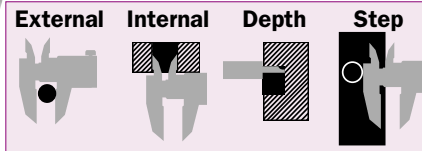

Range	Accuracy (mm)	Weight each	Order Code
150mm/ 6"	±0.03		-2260K
200mm/ 8"	±0.03		-2280K
300mm/12"	±0.03		-2320K

Standard Model with Data Output

Supplied in deluxe case with two batteries. Data cables sold separately.

Resolution 0.01mm/0.0005"

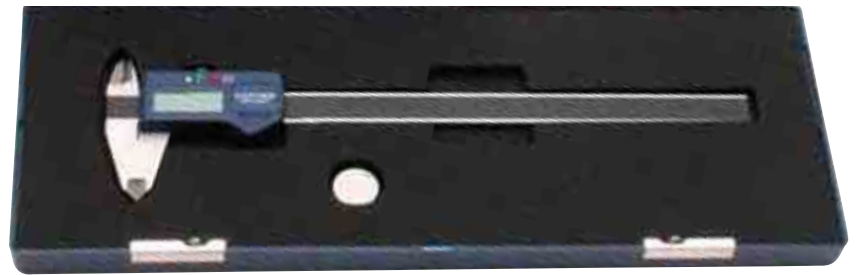

Extra batteries available - Order Code **EDI-904-4000K**.

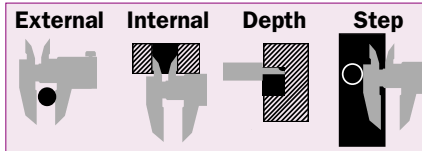

Range	Accuracy (mm)	Weight each	Order Code
200mm/8"	±0.03	500g	-3080K
300mm/12"	±0.03	750g	-3120K

Data Connecting Cables

With 4 pin jack and data hold button.

Pin Type	Length	Weight each	Order Code
Sub-D-Jack 9 Pin	1m	40g	-9010K
Flat Plug 10 Pin	2m	60g	-9020K

DATA OUTPUT

0 - 150mm/0 - 6" Digital Depth Gauge

Easy handling with inch/metric measurement, large digital display. External readings with zero set at any point fitted with a thumb wheel for greater accuracy.

IP 54

Protected against dust ingress and fluid splash

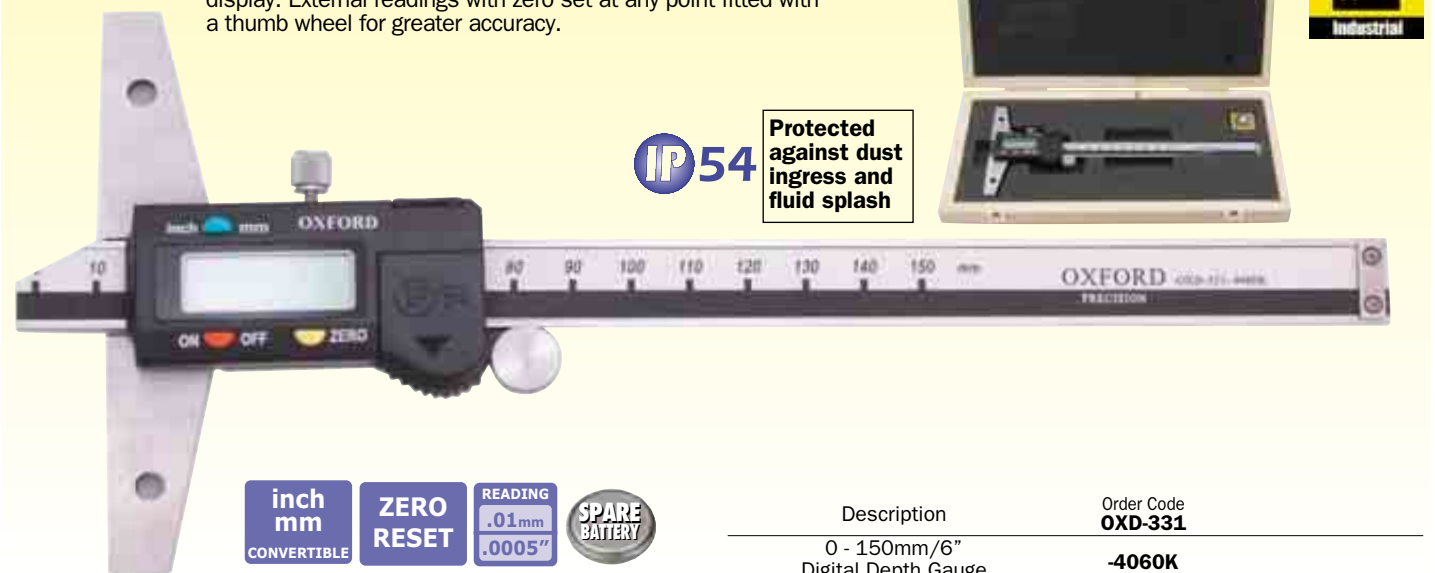

inch mm CONVERTIBLE ZERO RESET READING .01mm .0005" SPARE BATTERY

Description	Order Code
0 - 150mm/6" Digital Depth Gauge	-4060K

OXFORD PRECISION *Digital Electronic External Micrometer*



Easy handling with a large digital display, quick response speed and zero set at any point. Metric/inch measurement. The micrometer can be connected to a PC serial port by the SPC cable provided. **IP54** rating.

IP54

Protected against dust ingress and fluid splash

Range: 0 - 25mm/0 - 1".
Resolution: 0.001mm/0.00005".
Measuring force: 5 - 10N.
Accuracy: -0.004mm.



Range	Resolution	Order Code
0 - 25mm/0 - 1"	0.001mm/0.0005"	OXD-331

KENNEDY QUALITY INDUSTRIAL TOOLING *Digital Electronic External Micrometer*



Features one touch preset, lightweight design, LCD display, inch/metric conversion at the touch of a button, origin setting and error alarm, ratchet thimble type adjustment and carbide tipped measuring faces. IP65 coolant proof. Power supply: 1x SR44 battery, Order Code **PAN-904-5020K** supplied.

Accuracy: ±0.001mm"/0.00005".
Measuring Force: 5-10N.
Supplied in fitted bench case.



IP65

Protected against dust ingress and fluid splash

Resolution: 0.001mm/0.00005"

Range	Weight each	Order Code
0 - 25mm/0 - 1"	270g	KEN-331

Digital Protractor

This digital protractor has a range of 360° split into 4 x 90° quadrants. It is simple to calibrate and the intelligent display changes orientation at 90° and 270° to remain readable. It has a 'V' groove on the top and bottom for easy placement on acute angled or cylindrical objects. 3V lithium battery gives up to 2000 hours use. Complete with a leatherette pouch that has a belt loop.

NEW



Range	Weight each	Order Code
360° (4 x 90° Quadrants)		KEN-331

OXFORD PRECISION *IDS Digital Indicator*



Features:
Easy to use with clear digital LCD display. Large, easy-read 7.5mm LCD display. Soft-key touch for operator comfort. Superior construction quality. Response speed: ≤0.5m/s. Auto power off.



inch mm
CONVERTIBLE

ZERO RESET

TRAVEL
12.7mm
0.5"

READING
.001mm
.00005"

IP54

Protected against dust ingress and fluid splash

Description	Order Code
IDS Digital Indicator	OXD-331

Data Connecting Cables

Pin Type	Length	Weight each	Order Code
Sub-D-Jack 9 Pin	1m	40g	-9010K
Flat Plug 10 Pin	2m	60g	-9020K

IDM Digital Indicator

Features:
Easy to use with clear digital LCD display. Large, easy-read 7.5mm LCD display. Soft-key touch for operator comfort. Superior construction quality. Response speed: ≤0.5m/s. Auto power off.

Type IDM:
Inch/metric conversion, zero reset, data hold, min. max display, fast display, auto power off.



inch mm
CONVERTIBLE

ZERO RESET

TRAVEL
12.7mm
0.5"

READING
.001mm
.00005"

IP54

Protected against dust ingress and fluid splash

Description	Order Code
IDM Digital Indicator	OXD-331



KENNEDY *Magnetic Stand Fitments*
QUALITY INDUSTRIAL TOOLING

All main columns are threaded M8 x 1.25mm and are interchangeable with Kennedy, Oxford, Mitutoyo etc. base units except mini-mag (M6 x 1mm) also suitable for incorporating into special fixtures or threaded pot magnets.



Light Duty Fitment - Plain
Fitted as standard to **KEN-333-2010K**.

Column:
6.3 x 120mm.

Threaded:
M6 x 1mm.

6.3mm Standard Clamp To Suit	Weight each	Order Code KEN-333
1/4" I/D Lug, Stem/Spigot Dia. 5/16"	90g	-2500K
1/4" I/D Lug only	21g	-3200K

Heavy Duty Fitment - Fine Adjusting
Fitted as standard to **KEN-333-2060K** and **KEN-333-2050K**.



Column:
12 x 175mm.

Cross bar:
10 x 165mm with fine adjustment.

Threaded:
M8 x 1.25mm.

10mm Universal Clamp To Suit	Weight each	Order Code KEN-333
1/4" I/D Lug, Stem/Spigot Dia. 1/8", 1/4", 5/16" & 3/8"	442g	-2400K

Spare Knuckle Assemblies
For connecting columns and crossbars

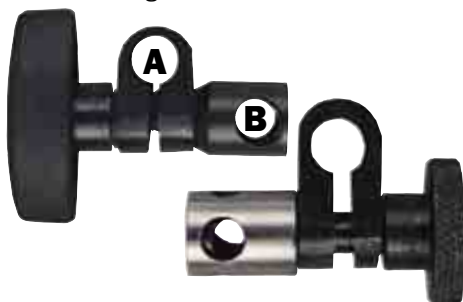

Accepts A & B	Weight each	Order Code KEN-333
1/4" & 5/16" O/D	50g	-3000K
10 & 10mm O/D	55g	-3010K
12 & 8mm O/D	58g	-2900K
12 & 10mm O/D	60g	-2920K

MAGNETIC BASES & COMPARATOR STANDS

Medium Duty Fitment - Plain
Fitted as standard to **KEN-333-2080K**.

Column:
12 x 185mm.

Cross bar:
6.3 x 150mm.

Threaded:
M8 x 1.25mm.



6.3mm Standard Clamp To Suit	Weight each	Order Code KEN-333
1/4" I/D Lug, Stem/Spigot Dia. 5/16"	420g	-2460K
1/4" I/D Lug only	21g	-3200K

Heavy Duty Fitment - Plain
Fitted as standard to **KEN-333-2100K** and **KEN-333-2030K**.



Column:
12 x 175mm.

Cross bar:
10 x 165mm.

Threaded:
M8 x 1.25mm.

10mm Universal Clamp To Suit	Weight each	Order Code KEN-333
1/4" I/D Lug, Stem/Spigot Dia. 1/8", 1/4", 5/16" & 3/8"	400g	-2420K

Crossbar Assembly
With lug adaptor, reduced sleeve
Fits over a 10mm bar.



Accepts	Weight each	Order Code KEN-333
6, 8 & 10mm Spigot 1/4" I/D Lug	85g	-3020K

Medium Duty Fitment - 3 Point
Fitted as standard to **KEN-333-2110K**.

3 point adjustable column:
15 x 280mm max.

Threaded:
M8 x 1.25mm.



3 Point Special Clamp To Suit	Weight each	Order Code KEN-333
1/4" I/D Lug, Dovetails Stem/Spigot Dia. 5/16"	312g	-2480K

Heavy Duty Fitment - Plain
Fitted as standard to **KEN-333-2070K**.

Column:
20 x 266mm.

Cross bar:
12 x 200mm.

Threaded:
M8 x 1.25mm.



14mm Universal Clamp To Suit	Weight each	Order Code KEN-333
1/4" I/D Lug, Stem/Spigot Dia. 1/8", 1/4", 5/16" & 3/8"	1450g	-2440K

Crossbar Assembly
With lug adaptor, reduced sleeve.
Fits over a 12mm bar.



Accepts	Weight each	Order Code KEN-333
6, 8 & 10mm Spigot 1/4" I/D Lug	85g	-3040K

GROUP 333 MAGNETIC BASES & COMPARATOR STANDS

KENNEDY Permanent Mag Stand
QUALITY INDUSTRIAL TOOLING

Mini-Mag Stand

With one magnetic face. Light duty with standard clamp, 30mm diameter keeper.

Mounts:

1/4" I/D lug, stem/spigot diameter: 5/16".

Column height x diameter:

120mm x 6.3mm.

Magnetic pull:

14.75kg.

Base dimensions:

30 x 35mm.



Overall Height	Weight each	Order Code
150mm	380g	KEN-333 -2010K

OXFORD Mini-Mag Stand
PRECISION

One magnetic face. Standard clamp. 30mm diameter base.

Mounts:

1/4" I/D lug, stem/spigot diameter: 5/16" and dovetail clamp.

Base dimensions:

30 x 35mm.

Column height x diameter:

150 x 6.3mm.

Crossbar length x diameter:

120 x 6.3mm.

Magnetic pull: 14kg.



Overall Height	Weight each	Order Code
150mm	0.38kg	OXD-333 -7010K

Universal 4 Mag Stand

With four magnetic faces, one at 45°. Universal clamp.

Mounts:

1/4" I/D lug, stem/spigot diameter: 1/8", 5/16" and 3/8".



Base dimensions:

60 x 50 x 55mm.

Column height x diameter:

175 x 12mm.

Crossbar x diameter:

160 x 10.0mm.

Magnetic pull: 30kg.

Overall Height	Weight each	Order Code
230mm	1.20kg	OXD-333 -7100K

Lever Switchable Universal 2 Mag Stand

With two magnetic faces and large vee. Heavy duty with universal clamp.

Mounts:

1/4" I/D lug, stem/spigot diameter: 1/8", 1/4".



Overall Height	Weight each	Order Code
230mm	1.2kg	KEN-333 -2030K

Universal 2 Mag Stand

Lever type, two magnetic faces and large vee. With universal clamp.

Mounts:

1/4" I/D lug, stem/spigot diameter: 1/8", 1/4".

Base dimensions:

60 x 65 x 55mm.

Column height x diameter:

175 x 12mm.

Crossbar length x diameter:

160 x 10.0mm.

Magnetic pull: 50kg.

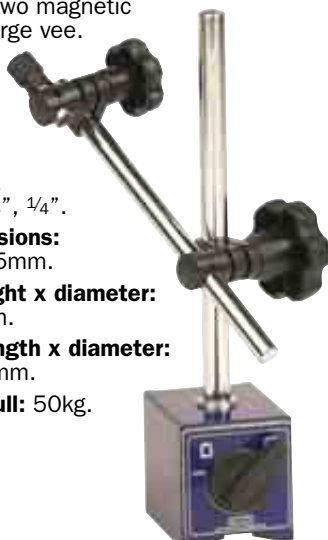

Overall Height	Weight each	Order Code
230mm	1.20kg	OXD-333 -7030K

Lever Switchable Fine Adj. 2 Mag Stand

With two magnetic faces and large vee. Heavy duty with universal clamp and fine adjustment.

Mounts:

1/4" I/D lug, stem/spigot diameter: 1/8", 1/4".

Base dimensions:

60 x 50 x 55mm.

Column height x diameter:

175 x 12mm.

Crossbar length x diameter:

165 x 10mm.

Magnetic pull: 50kg.

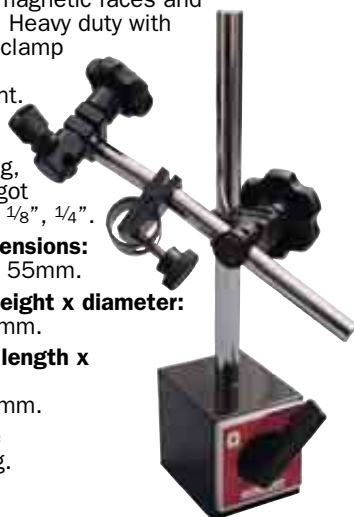

Overall Height	Weight each	Order Code
230mm	1.2kg	KEN-333 -2050K

Fine Adjustment 2 Mag Stand

Lever type two magnetic faces and large vee. Universal clamp.

Mounts:

1/4" I/D lug, stem/spigot diameter: 1/8", 1/4".

Base dimensions:

60 x 50 x 55mm.

Column height x diameter:

175 x 12mm.

Crossbar length x diameter:

160 x 10.0mm.

Magnetic pull: 50kg.

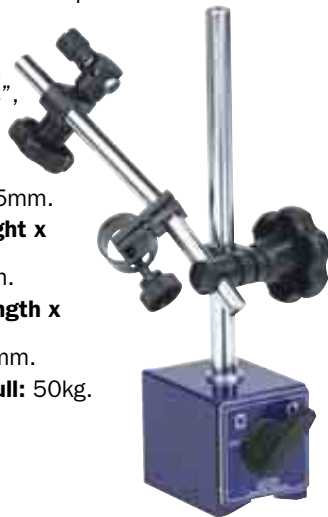

Overall Height	Weight each	Order Code
230mm	1.20kg	OXD-333 -7050K

Compact 4 Mag Stand

With four magnetic faces, one at 45°. Standard clamp.

Mounts:

1/4" I/D lug, stem/spigot diameter: 5/16".

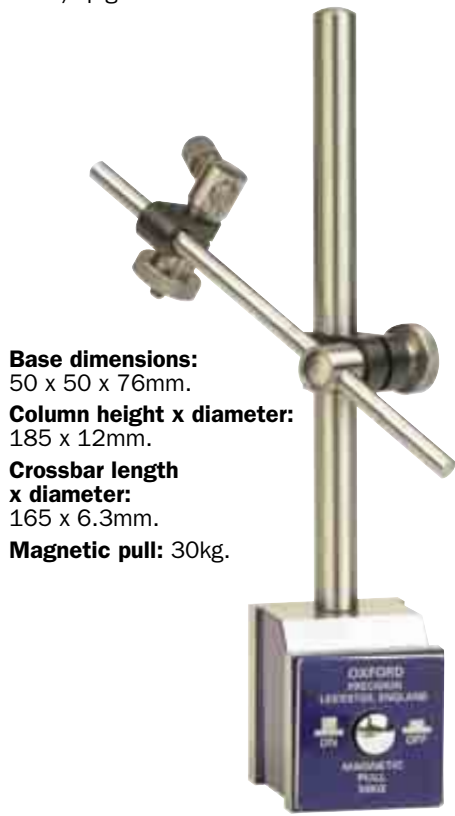

Base dimensions:

50 x 50 x 76mm.

Column height x diameter:

185 x 12mm.

Crossbar length x diameter:

165 x 6.3mm.

Magnetic pull: 30kg.

Overall Height	Weight each	Order Code
280mm	1.90kg	OXD-333 -7080K



Precision & Laboratory Equipment



KENNEDY
QUALITY INDUSTRIAL TOOLING

**Lever Switchable
Elbow Joint 2 Mag Stand**

With two magnetic faces and large vee. Medium duty special clamp with fine adjustment.

Mounts:
1/4" I/D lug, dovetail stem/spigot diameter: 5/16".

Base dimensions:
60 x 50 x 55mm.

Column height x diameter:
Up to 280 x 15mm.

Magnetic pull: 50kg.



Elbow Joint	Weight each	Order Code
2 Mag	1.2kg	-2110K

Major 4 Mag Stand

With four magnetic faces, one at 45°. Heavy duty with universal clamp.

Mounts:
1/4" I/D lug, stem/spigot diameter: 1/4", 5/16".

Base dimensions:
64 x 64 x 76mm.

Column height x diameter:
266 x 20mm.

Crossbar length x diameter:
200 x 14.0mm.

Magnetic pull: 80kg.

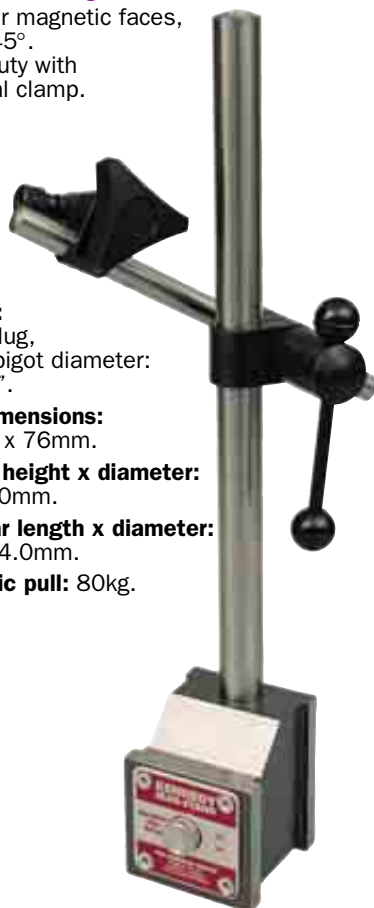

Overall Height	Weight each	Order Code
380mm	3.00kg	-2070K

MAGNETIC BASES & COMPARATOR STANDS

Fine Adjusting 4 Mag Stand

With four magnetic faces, one at 45°. Heavy duty with universal clamp and fine adjustment.

Mounts:
1/4" I/D lug, stem/spigot diameter: 1/8", 1/4".

Base dimensions:
64 x 64 x 76mm.

Column height x diameter:
175 x 12mm.

Crossbar length x diameter:
165 x 10.0mm.

Magnetic pull: 80kg.



Overall Height	Weight each	Order Code
280mm	1.90kg	-2060K

Universal 4 Mag Stand

With four magnetic faces, one at 45°. Heavy duty with universal clamp.

Mounts:
1/4" I/D lug, stem/spigot diameter: 1/8", 5/16" and 3/8".

Base dimensions:
48 x 40 x 50mm.

Column height x diameter:
175 x 12mm.

Crossbar length x diameter:
165 x 10.0mm.

Magnetic pull: 30kg.



Overall Height	Weight each	Order Code
227mm	0.90kg	-2100K

Compact 4 Mag Stand

With four magnetic faces, one at 45°. Medium duty with standard clamp.

Mounts:
1/4" I/D lug, stem/spigot diameter: 5/16".

Base dimensions:
50 x 50 x 76mm.

Column height x diameter:
185 x 12mm.

Crossbar length x diameter:
150 x 6.3mm.

Magnetic pull: 30kg.

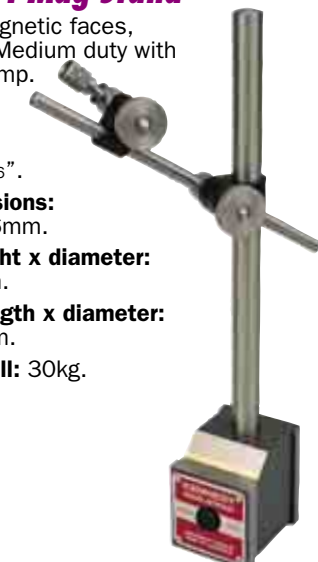

Overall Height	Weight each	Order Code
2273	0.89kg	-2080K

Lever Type Base - 50kg

Fitted as standard to **KEN-333-2030K**, **-2050K** and **-2110K** two magnetic bottom and back face.

Large vee for curved surfaces.

Threaded: M8 x 1.25mm.

Base dimensions: 60 x 50 x 55mm.

Magnetic pull: 50kg.



Magnetic Pull	Weight each	Order Code
50kg	850g	-2240K

Push Button Base - 30kg

Fitted as standard to **KEN-333-2080K** and **-2100K**. Four magnetic faces, bottom, sides and 45° angle face for curved surfaces.

Threaded: M8 x 1.25mm.

Magnetic pull: 30kg.



Magnetic Pull	Weight each	Order Code
30kg	850g	-2220K

Push Button Base - 80kg

Fitted as standard to **KEN-333-2060K** and **-2070K**. Four magnetic faces, bottom, sides and 45° angle face for curved surfaces.

Threaded: M8 x 1.25mm.

Magnetic pull: 80kg.



Magnetic Pull	Weight each	Order Code
80kg	850g	-2200K

GROUP 335 MICROMETERS - BORE

OXFORD PRECISION 3 Point Bore Micrometer Sets

Designed to self-centre, for accurate measuring of bores. Satin finish, fitted with knurled ratchet stop.



Precision & Laboratory Equipment

OXD-335-2490K - Contents:

Micrometers: 6 - 8mm, 8 - 10mm, 10 - 12mm.
 Calibration rings: 8 and 10mm.
 Slotted screwdrivers, 2 x spanners, extension bar.



OXD-335-2500K - Contents:

Micrometers: 11 - 14mm, 14 - 17mm, 17 - 20mm.
 Slotted screwdrivers, 2 x spanners, extension bar for measuring 170mm deep. Calibration rings: 14 and 17mm.



OXD-335-2510K - Contents:

Micrometers: 20 - 25mm, 25 - 30mm, 30 - 35mm, 35 - 40mm.
 Slotted screwdrivers, 2 x spanners, extension bar for measuring 220mm deep.
 Calibration rings: 25 and 35mm.

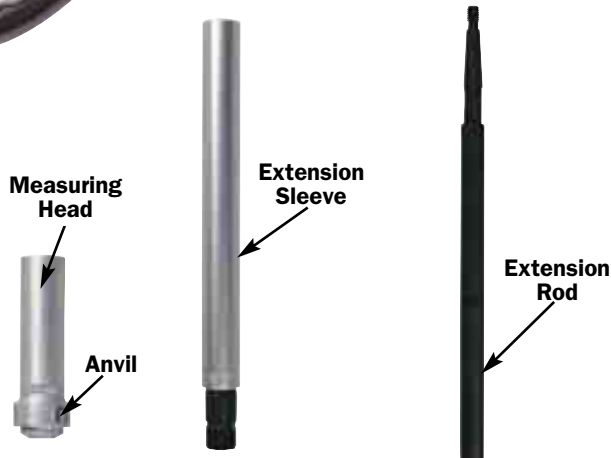
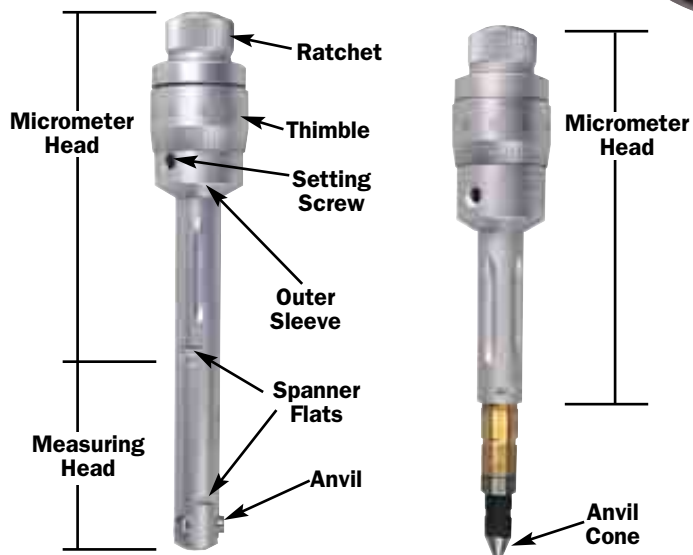

Range (mm)	Number of Micrometers	Weight each	Order Code
6 - 12mm	3		-2490K
11 - 20mm	3		-2500K
20 - 40mm	4		-2510K

OXFORD Enamelled Frame
PRECISION External Micrometers

With enamelled frame and tungsten carbide tipped anvils. High quality fitted metal case with adjusting spanner. Sizes 25 - 50mm/1 - 2" and over supplied with setting standard. Manufactured to BS 870. All supplied in a impact resistant fitted plastic case.

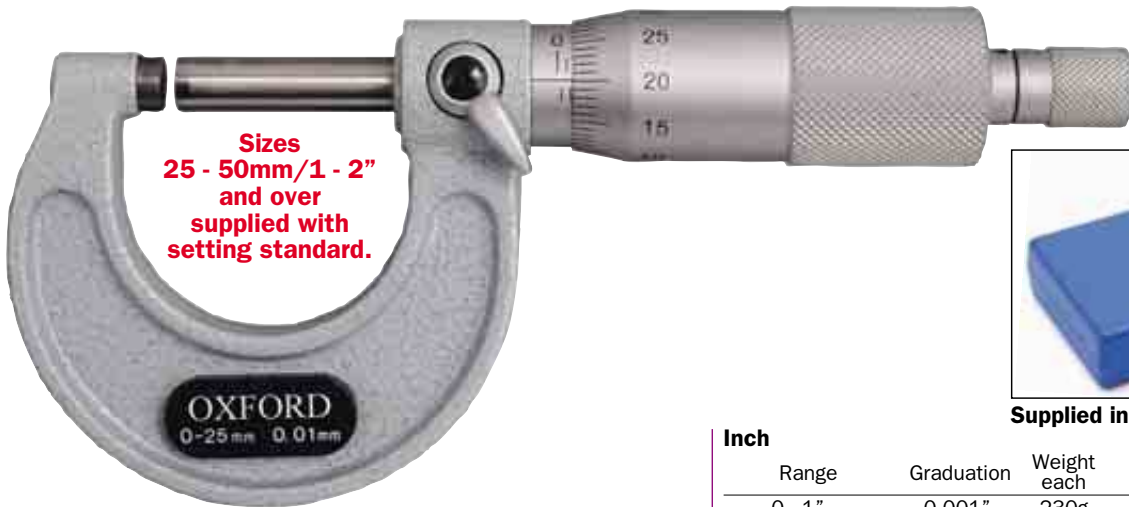

Supplied in case.



Inch

Range	Graduation	Weight each	Order Code OXD-335
0 - 1"	0.001"	230g	-6010K
1 - 2"	0.001"	300g	-6020K
2 - 3"	0.001"	400g	-6030K
3 - 4"	0.001"	530g	-6040K
4 - 5"	0.001"	770g	-6050K
5 - 6"	0.001"	800g	-6060K

Micrometer Setting Standards

For setting external micrometers, calipers etc. to zero, providing accurate repeatability of measurements. Flat, lapped measuring ends with fitted heat insulation block. Manufactured to BS 870.



Size	Weight each	Order Code OXD-335	Size	Weight each	Order Code OXD-335
25mm	10g	-7010K	1"	10g	-7110K
50mm	10g	-7020K	2"	10g	-7120K
75mm	20g	-7030K	3"	20g	-7130K
100mm	30g	-7040K	4"	30g	-7140K
125mm	40g	-7050K	5"	40g	-7150K

Metric

Range	Graduation	Weight each	Order Code OXD-335
0 - 25mm	0.01mm	230g	-5010K
25 - 50mm	0.01mm	300g	-5020K
50 - 75mm	0.01mm	400g	-5030K
75 - 100mm	0.01mm	530g	-5040K
100 - 125mm	0.01mm	770g	-5050K
125 - 150mm	0.01mm	800g	-5060K
150 - 175mm	0.01mm		-5070K
175 - 200mm	0.01mm		-5080K
200 - 225mm	0.01mm		-5090K
225 - 250mm	0.01mm		-5100K
250 - 275mm	0.01mm		-5110K
275 - 300mm	0.01mm		-5120K

KENNEDY Enamelled Frame
QUALITY INDUSTRIAL TOOLING External Micrometers

Enamelled frame and tungsten carbide tipped anvils. Manufactured to BS 870.



Supplied in case.

Accuracy:

Flatness: 0.6mm.

Parallelism: $(2 + L/100)\mu\text{m}$
(fraction rounded down).

Instrumental error: $\pm(1 + L/75)\mu\text{m}$
(fraction rounded up).

L = maximum measuring length.

Metric

Range	Graduation	Weight each	Order Code KEN-335
0 - 25mm	0.01mm	230g	-0010K
25 - 50mm	0.01mm	300g	-0020K
50 - 75mm	0.01mm	400g	-0030K
75 - 100mm	0.01mm	530g	-0040K
100 - 125mm	0.01mm	770g	-0050K
125 - 150mm	0.01mm	800g	-0060K



GROUP 335 MICROMETERS - EXTERNAL

OXFORD Precision Tool Set

Multi purpose precision set supplied in plastic fitted bench case.

Contents:

0 - 25mm and 25 - 50mm external micrometer, 25mm setting standard, two micrometer setting spanners, 125mm/5" vernier caliper, 150mm/6" rule with pocket clip, 300mm/12" engineers rule, 100mm engineers square, pocket scriber with clip.



Precision & Laboratory Equipment

Description	Weight each	Order Code
10 Piece Precision Set	150g	OXD-335 -9000K

External Micrometer Sets

With enamelled frame and tungsten carbide tipped anvils and fine adjustment ratchet. Supplied in plastic fitted bench case.

Contents:

-5500K

0 - 25mm, 25 - 50mm, 50 - 75mm and 75 - 100mm external micrometers, 25mm, 50mm and 75mm micrometer setting standards, two micrometer setting spanners.

-6600K

0 - 1", 1 - 2", 2 - 3" and 3 - 4" external micrometers, 1", 2" and 3" micrometer setting standards, two micrometer setting spanners.



Range	Graduation	Weight each	Order Code
0 - 100mm	0.01mm		OXD-335 -5500K
0 - 4"	0.0001"		-6600K

OXFORD PRECISION *Apprentice Engineer's Tool Set*

Contents

150mm (6") engineer's rule, 0 - 25 and 25 - 50mm micrometers, 25mm setting standard, 10x magnification eye loupe, 150 (6") digital caliper, 0.5 - 1.0mm 20 blade feeler gauge, 51 metric 60° screw pitch gauge, pocket scriber. Technical data handbook.



Precision & Laboratory Equipment

Description	Weight each	Order Code
10 Pce Engineers Tool Set		OXD-335 -9200K

Multi Anvil Micrometer Set

An external micrometer with seven pairs of interchangeable anvils. For measuring grooves, threads, bearings, tube and sheet.

Anvils Included:

12mm disc, 5.5mm blade, 60° cone and blade, 6.5mm radius, 6.5 and 2mm flat.



Range	Graduation	Weight each	Order Code
0 - 25mm	0.01mm		OXD-335 -3250K

PRODUCTS ARE ONLY AVAILABLE VIA YOUR DISTRIBUTOR

GROUP 335 MICROMETERS - EXTERNAL

OXFORD PRECISION Interchangeable Anvil Micrometer

Carbide tipped spindle faces. Hardened and ground anvils. Supplied in metal case with adjusting spanner. Four anvils and three setting standards.

Accuracy: $\pm (4+L/75)$ mm.

Measuring faces flatness: ± 0.6 mm.

Parallelism: $(2+L/100)$ mm.



Precision & Laboratory Equipment



Range	Graduation	Weight each	Order Code
0 - 100mm	0.01mm	850g	OXD-335 -3000K
0 - 150mm	0.01mm	990g	-3020K

Interchangeable Anvil Micrometers

Oxfords versatile range of micrometers with interchangeable anvils, ratchet top, lock, setting standards and wooden case. Rigid and stable cast iron frame that's perforated for lightness.



NEW

Range	Graduation	Weight each	Order Code
300 - 400mm	0.01mm		OXD-335 -3100K
400 - 500mm	0.01mm		-3120K
500 - 600mm	0.01mm		-3140K

OXFORD PRECISION Mechanical Digital Micrometer — 0 - 25mm

Direct reading external micrometer for quick and easy reading. With enamelled frame and tungsten carbide precision ground micro finish measuring faces. Measuring range 0 - 25mm. Graduation 0.01mm, 0.5mm screw pitch with lock.



Range	Graduation	Weight each	Order Code
0 - 25mm	0.01		OXD-335 -4100K

30° Anvil Micrometers

Used for measuring within small grooves or recesses and for quick comparisons of thread accuracy in screw cutting operations. With knurled thimble, ratchet stop and thumb lock. Enamelled frame with satin chromed finish barrel and sleeve.



Range	Graduation	Weight each	Order Code
0 - 25mm	0.01mm	250g	OXD-335 -3520K

Wire Micrometer

Specially designed for measuring wire diameters 0 - 10mm. The front of the body is flat to help support the wire when measuring. With knurled thimble, ratchet stop and vernier scale barrel, all over satin chrome finish.



Capacity	Graduation	Weight each	Order Code
0 - 10mm	0.002mm	150g	OXD-200 -2000K

GROUP 336/338 REFRACTOMETERS/STEEL GAUGE BLOCKS

OXFORD PRECISION Portable Optical Refractometer

For determining the concentration of oil in water emulsions and transparent solutions, such as machine shop coolant. Maintaining the correct mixture in coolant systems is vital to ensure optimum performance from cutting tools. To protect the machine and workpiece from corrosion and to reduce the risk of health hazards arising from incorrect concentrations of water soluble oils. To economise the use of water base cutting fluids and grinding fluids.



Lens for Portable Refractometer

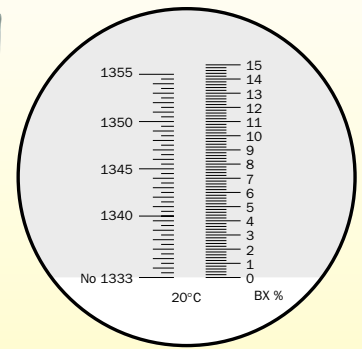

Calibrated Refractive Scale

Specifications:

Range ND: 1.333 - 1.356. Bx: 0 - 15%.

Eyepiece magnification: 11x.

Telescopic lens magnification: 4x.

Accuracy: $\pm 0.0003 \pm 0.2\%$

Lattice value: 0.0005 0.2%

Supplied in high quality fitted metal case complete with calibration screwdriver and operator manual.

Refractometer

Dimensions	Weight each	Order Code
38 x 38 x 185mm	30g	OXD-336 -1010K

Spares

Description	Weight each	Order Code
Lens for Portable Refractometer	10g	OXD-398 -3630K

KENNEDY Steel Gauge Block Sets

Supplied in high quality wooden bench cases, complete with certificate of calibration. Available in two grades. Manufactured to **BS EN ISO 3650**.



Grade 2: For Workshop Use

No. of Pieces	Range (inclusive)	Increments	Weight each	Order Code
36 Piece Inch				
(2)	.05"-.10"	.05"	2.4kg	-3360K
(9)	.1001-.1009"	.0001"		
(9)	.101-.109"	.001"		
(9)	.110-.190"	.010"		
(4)	.2-.5"	.10"		
(3)	1, 2 & 4"			
81 Piece Inch				
(9)	.1001-.1009"	.0001"	4.0kg	-3810K
(49)	.101-.149"	.001"		
(19)	.05-.95"	.05"		
(4)	1-4"	1"		
47 Piece Metric				
(1)	1.005mm		2.1kg	-4470K
(9)	1.01-1.09mm	.01mm		
(9)	1.1-1.9mm	.1mm		
(24)	1-24mm	1mm		
(4)	25-100mm	25mm		
88 Piece Metric				
(1)	1.0005mm		2.8kg	-4880K
(9)	1.001-1.009mm	.001mm		
(49)	1.01-1.49mm	.01mm		
(20)	.5-10mm	.5mm		
(9)	20-100mm	10mm		



Grade 1: For Inspection Use

No. of Pieces	Range (inclusive)	Increments	Weight each	Order Code
81 Piece Inch				
(9)	.1001-.1009"	.0001"	4.0kg	-4810K
(49)	.101-.149"	.001"		
(19)	.05-.95"	.05"		
(4)	1-4"	1"		
47 Piece Metric				
(1)	1.005mm		2.4kg	-5470K
(9)	1.01-1.09mm	.01mm		
(9)	1.1-1.9mm	.10mm		
(24)	1-24mm	1mm		
(4)	25-100mm	25mm		
88 Piece Metric				
(1)	1.0005		2.8kg	-5880K
(9)	1.001-1.009mm	.001mm		
(49)	1.01-1.49mm	.01mm		
(20)	.5-10mm	.5mm		
(9)	20-100mm	10mm		



Precision & Laboratory Equipment

KENNEDY Engineer's Squares
QUALITY INDUSTRIAL TOOLING



Manufactured from hardened and tempered steel.

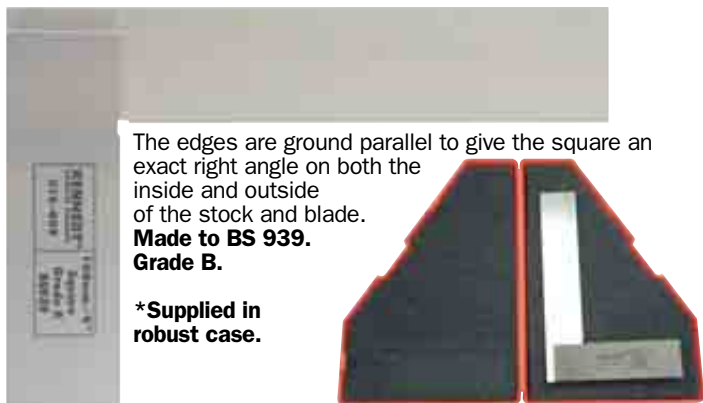

The edges are ground parallel to give the square an exact right angle on both the inside and outside of the stock and blade.

Made to BS 939. Grade B.

*Supplied in robust case.

Size (mm)	Weight each	Order Code KEN-518
75 (3")*	140g	-4030K
100 (4")*	270g	-4040K
150 (6")*	320g	-4060K
225 (9")	1400g	-4090K
300 (12")	2000g	-4120K

Adjustable Steel Squares

Made from hardened steel ,precision ground, with three blades, one plain, parallel blade for use as an engineer's square, 30° and 45° bevel edged blade for checking angles, and a narrow blade graduated metric and inch.

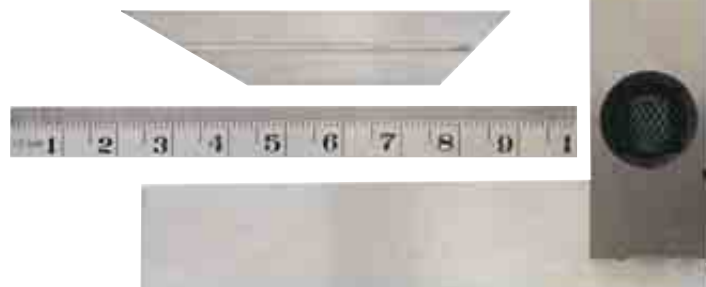

Measured Length	Weight each	Order Code KEN-518
100mm/4"	340g	-4150K
150mm/6"	410g	-4160K

OXFORD Engineer's Squares
PRECISION



Engineer's steel squares that are precision manufactured from hardened steel that has been precisely ground to produce parallel edges so that the square has an exact right angle on both the inside and outside of the stock and blade, to ensure accuracy. Made to **British Standard BS 939.**

Size (mm)	Order Code OXD-340
75 (3")	-0030K
100 (4")	-0040K
150 (6")	-0060K
225 (9")	-0090K
300 (12")	-0120K

200mm Precision Prism Level

Two plastic knobs insulate the level from the hand's heat. Reading: 0.0005" per foot (10 seconds) (0.05mm/m). V-grooved base allows levelling cylindrical surfaces. Two graduated vials allow for transverse and horizontal settings. Packed in strong, wooden, fitted case.

Dimensions:
Level: 200 x 50 x 40mm.
Case: 235 x 80 x 50mm.



Dimensions (W x D x Hmm)	Base	Weight each	Order Code OXD-340
200 x 50 x 40	200mm	1.9kg	-5000K

KENNEDY Screw Plug Gauges
QUALITY INDUSTRIAL TOOLING

EXTENDED RANGE

Double Ended Go & No Go

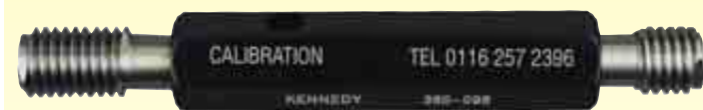

Thread Size	Weight each	Order Code KEN-360
Metric Coarse — Class 6H Tolerance		
M2.0 x 0.40	4g	-0810K
M2.5 x 0.45	4g	-0830K
M3.0 x 0.50	4g	-0840K
M4.0 x 0.70	10g	-0860K
M5.0 x 0.80	12g	-0880K
M6.0 x 1.00	14g	-0890K
M7.0 x 1.00	26g	-0900K
M8.0 x 1.25	28g	-0910K
M9.0 x 1.25	28g	-0920K
M10.0 x 1.50	52g	-0930K
M12.0 x 1.75	70g	-0950K
M14.0 x 2.00	108g	-0960K
M16.0 x 2.00	128g	-0970K
M18.0 x 2.50	132g	-0980K
M20.0 x 2.50	148g	-0990K
M24.0 x 3.00	272g	-1010K
M30.0 x 3.50	484g	-1030K
M36.0 x 4.00	622g	-1050K

Screw Ring Gauges

Made from the finest quality steel and are thoroughly hardened, stabilised and thread ground under strict quality control procedures ensuring a high quality product for optimum wear life.

EXTENDED RANGE



Thread Size	Weight each	Order Code KEN-361
Metric Coarse — Class Tolerance 6G		
M2.0 x 0.40	8g	-0070K
M3.0 x 0.50	8g	-0100K
M4.0 x 0.70	14g	-0120K
M5.0 x 0.80	16g	-0140K
M6.0 x 1.00	50g	-0150K
M8.0 x 1.25	58g	-0170K
M10.0 x 1.50	66g	-0190K
M12.0 x 1.75	96g	-0210K
M16.0 x 2.00	176g	-0230K
M20.0 x 2.50	206g	-0250K
M24.0 x 3.00	244g	-0270K

GROUP 370 STEEL VEE BLOCKS, SQUARES & SURFACE PLATES

OXFORD Vee Blocks
PRECISION

Matched and numbered pairs of closed grained iron castings accurately machined. Precision 90° vee blocks. Supplied as a pair.

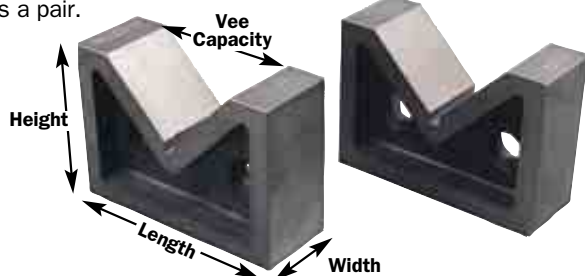

Dimensions L x W x H	Vee Capacity	Weight/ Pair	Order Code OXD-370
75 x 33 x 60mm	45	1.7kg	-2110K
100 x 40 x 65mm	56	2.9kg	-2120K
125 x 50 x 78mm	62	4.8kg	-2130K
150 x 62 x 88mm	78	6.5kg	-2140K
200 x 100 x 140mm	113	11.2kg	-2150K
250 x 125 x 165mm	125	19.0kg	-2160K

Workshop Grade Hollow Ground Vee Blocks & Clamp

Designed for checking precision machine parts. Hardened and precision ground steel supplied in matched pairs, each with V-grooves central and parallel to the sides and base ensuring perfect alignment.

Complete set with two V-blocks (one pair) and two clamps. Supplied with malleable iron clamps with steel screws.



Dimensions Length x Width x Height	Weight/ Pair	Order Code OXD-370
31.5 x 40 x 31.5mm	1.7kg	-2310K

Workshop Vee Blocks & Clamp

Designed for checking precision machine parts. Hardened and precision ground steel supplied in matched pairs, each with V-grooves central and parallel to the sides and base ensuring perfect alignment.

Complete set with two V-blocks (one pair) and two clamps.



Dimensions Length x Width x Height	Weight/ Pair	Order Code OXD-370
50 x 37 x 37mm	1.0kg	-2300K

Plain Surface Plates

Surface plates are used when a precision surface is key. These plates are manufactured from high quality, close grained cast iron and are stress relieved against distortion by heat treatment. Rigidity and long lasting accuracy are ensured by adequate top and side thickness and ribbed construction. The surfaces are free from pin holes, planed and hand scraped. Manufactured to **BS 817**.

Product Number	Description	Dimensions Length x Width	Weight each	Order Code OXD-371
SP4	Grade 1	300 x 200mm	11kg	-2000K
SP6		300 x 300mm	18kg	-2020K
SP11		450 x 300mm	39kg	-2040K
SP4	Grade 2	300 x 200mm	11kg	-2200K
SP11		450 x 300mm	39kg	-2240K

Adjustable Swivel Angle Surface Plates

With radial locking hardened and ground pins and plain slotted top, are made from close grained cast iron with a Grade 2 ground finish.



3 - 4 Day Delivery

Type	Dimensions Length x Width	Weight each	Order Code OXD-370
SA1P	150 x 127mm	6kg	-1720K
SA2P	210 x 150mm	12kg	-1740K
SA4P	250 x 200mm	22kg	-1760K

Angle Plates

Open End

Open end angle plates are versatile accessories which can be used to clamp and hold work in a vertical position for planing, milling, or drilling. Work can be clamped and rotated through several planes for measurement or machining without repositioning. The slots allow work to be easily fastened to the plate, and the plate to a fixture base or machine bed.

Manufactured from close grained cast iron. **BS : 5535 Grade B.**



Dimensions Length x Width x Height	Weight each	Order Code OXD-370
3 1/2" x 3" x 2 1/2"	4.60kg	-1310K
4 1/2" x 3 1/2" x 3"		-1320K
6" x 5" x 4 1/2"		-1340K
8" x 6" x 5"		-1350K
10" x 8" x 6"		-1360K
12" x 9" x 8"	-1370K	

Webbed End

Webbed slotted angle plates can be used for rapid mounting fixtures for machine set-up, layout, or inspection. They are heavily ribbed for strength and rigidity. Sides and ends are machine finished. Manufactured from close grained cast iron.

BS : 5535 Grade B.



Dimensions Length x Width x Height	Weight each	Order Code OXD-370
3 1/2" x 3" x 2 1/2"	1.4kg	-1100K
4 1/2" x 3 1/2" x 3"	1.5kg	-1110K
6" x 5" x 4 1/2"	6.1kg	-1120K
8" x 6" x 5"	10.4kg	-1140K
10" x 8" x 6"	15.6kg	-1160K
12" x 9" x 8"	26.5kg	-1170K

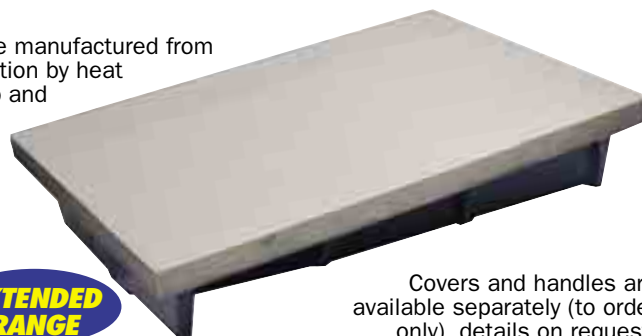

Covers and handles are available separately (to order only), details on request.



PRODUCTS ARE ONLY AVAILABLE VIA YOUR DISTRIBUTOR



Hardened and ground steel parallels for workshop use. Supplied in pairs for packing or levelling components prior to machining in tool rooms or machine shops.

Supplied in Pairs

EXTENDED RANGE



Dimensions Length x Width x Height	Weight/ Pair	Order Code OXD-372
8 x 15 x 100mm		-4080K
10 x 4 x 160mm		-3700K
10 x 20 x 100mm		-4100K
12 x 20 x 100mm		-4120K
14 x 4 x 150mm		-3800K
14 x 4 x 160mm		-3710K
16 x 4 x 150mm		-3810K
16 x 25 x 150mm		-4160K
18 x 4 x 140mm		-3720K
18 x 4 x 150mm		-3820K
20 x 4 x 150mm		-3830K
20 x 30 x 200mm		-4200L
22 x 4 x 140mm		-3730K
22 x 4 x 150mm		-3840K
24 x 4 x 150mm		-3850K
25 x 40 x 250mm		-4250K
26 x 4 x 140mm		-3740K
26 x 4 x 150mm		-3860K
28 x 4 x 150mm		-3870K
30 x 4 x 140mm		-3750K
30 x 4 x 150mm		-3880K
32 x 4 x 150mm		-3890K
34 x 4 x 140mm		-3760K
35 x 4 x 150mm		-3900K
38 x 4 x 140mm		-3770K
40 x 4 x 150mm		-3910K
42 x 4 x 140mm		-3780K
45 x 4 x 150mm		-3920K
50 x 4 x 150mm		-3930K

18 Piece Set

Contents: nine pairs of the following sizes:

- 10 x 4 x 160mm,
- 14 x 4 x 160mm,
- 18 x 4 x 140mm,
- 22 x 4 x 140mm,
- 26 x 4 x 140mm,
- 30 x 4 x 140mm,
- 34 x 4 x 140mm,
- 38 x 4 x 140mm,
- 42 x 4 x 140mm.

Supplied in wooden storage box.

18
PIECES



Description	Weight each	Order Code OXD-372
18 Piece Set	2.8kg	-3620K

16 Piece Set

Contents: eight pairs of the following sizes:

- 5 x 16 x 100mm, 6 x 18 x 100mm, 8 x 24 x 100mm,
- 10 x 30 x 100mm, 12 x 36 x 150mm, 14 x 48 x 150mm,
- 18 x 60 x 150mm, 22 x 62 x 150mm. And support blocks.



16
PIECES

Description	Weight each	Order Code OXD-372
16 Piece Set	12.7kg	-3600K

28 Piece Set

Contents:

Contents: fourteen pairs of the following sizes:

- 14 x 4 x 150mm, 16 x 4 x 150mm, 18 x 4 x 150mm,
- 20 x 4 x 150mm, 22 x 4 x 150mm, 24 x 4 x 150mm,
- 26 x 4 x 150mm, 28 x 4 x 150mm, 30 x 4 x 150mm,
- 32 x 4 x 150mm, 35 x 4 x 150mm, 40 x 4 x 150mm,
- 45 x 4 x 150mm, 50 x 4 x 150mm.

Supplied in wooden storage box.

NEW

28
PIECES



Description	Weight each	Order Code OXD-372
28 Piece Set	11.5kg	-3640K